

CR..AD - CR..AD1 - CR..AD2 plates

enclosures

size "49.16"	from page 374
size "66.16"	from page 378
size "44.27"	from page 387
size "57.27"	from page 393
size "77.27"	from page 402

Use M3 passing screws tightened with nut and washer (not included).
Verify connection continuity of coupled connectors

adapter plates for D-Sub inserts
(IEC 60807-2) CZ / MZ / MZF enclosures



adapter plates for D-Sub inserts
(IEC 60807-2) CH / CA and MH / MA / MF enclosures

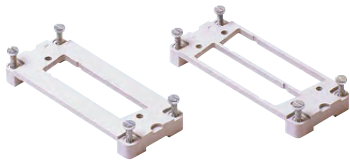

description	part No.	for enclosures size	part No.	for enclosures size
for 1 D-Sub insert 9 poles (not included)	CR 09 AD	"49.16"	CR 09 AD1	"44.27"
for 1 D-Sub insert 15 poles (not included)	CR 15 AD	"49.16"	CR 15 AD1	"44.27"
for 1 D-Sub insert 25 poles (not included)	CR 25 AD	"49.16"	CR 25 AD1	"57.27"
for 1 D-Sub insert 37 poles (not included)	CR 37 AD	"66.16"	CR 37 AD1	"77.27"
for 1 D-Sub insert 50 poles (not included)	CR 50 AD	"66.16"	CR 50 AD1	"77.27"
for 2 D-Sub inserts 9 poles (not included)			CR 09 AD2	"44.27"
for 2 D-Sub inserts 15 poles (not included)			CR 15 AD2	"44.27"
for 2 D-Sub inserts 25 poles (not included)			CR 25 AD2	"57.27"
for 2 D-Sub inserts 37 poles (not included)			CR 37 AD2	"77.27"
for 2 D-Sub inserts 50 poles (not included)			CR 50 AD2	"77.27"

Plates CR...AD, CR...AD1 and CR...AD2
For machinery or command equipment that need connection with programming and control electronic devices. The plate housings have notches for the rear insertion of cabled D-Sub inserts.

CR...AD
mounting on bulkhead housings and hoods
one-way mounting in bulkhead housings or hoods.

CR...AD1 and CR...AD2
mounting on bulkhead housings (Figure 1)
The D-Sub connector must be mounted on the side marked with the letter "A"

Mounting on hoods (Figure 2)
The D-Sub connector must be mounted on the side marked with the letter "T"

CR...AD

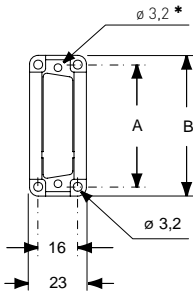

* For pass-through screws type M3
The electrical continuity is guaranteed only if mounted in our enclosures.

part No.	A	B
CR 09 AD	49,5	56,5
CR 15 AD	49,5	56,5
CR 25 AD	49,5	56,5
CR 37 AD	66	73,5
CR 50 AD	66	73,5

CR...AD1

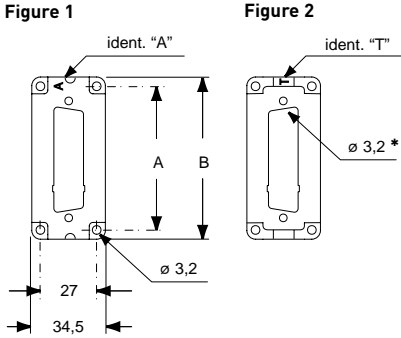

* For pass-through screws type M3

CR...AD2

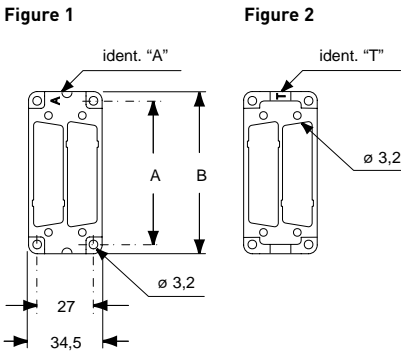

* For pass-through screws type M3

part No.	A	B
CR 09 AD1 / 2	44	51,5
CR 15 AD1 / 2	44	51,5
CR 25 AD1 / 2	57	64,5
CR 37 AD1 / 2	77,5	85
CR 50 AD1 / 2	77,5	85



SDS - CHSDS kit for control equipment

enclosures *)
size "104.62"
C-TYPE IP65/IP66
page: 430
*) normally bulkhead type

kit for control equipment
plate only



kit for control equipment
plate with enclosure



description	part No.	for enclosures	part No.
-------------	----------	----------------	----------

with Schuko® socket 16A and 2 seats for:
CR 09 AD, CR 15 AD, CR 25 AD plates
with Schuko® socket 16A and 2 seats for:
CR 09 AD, CR 15 AD, CR 25 AD plates

SDS

CHI 48 LS

CHSDS

Kit for control equipment

For machinery or command equipment that need connection with programming and control electronic devices.
The kit includes the Schuko® socket and 2 seats for the CR...AD plates (not included) for D-sub inserts (not included).
Personal computers, notebooks or printers can be power supplied using a 16A socket.
Monitors, printers and other peripheral devices may be interfaced using D-sub connectors

CR...AD usable plates

part No.	
CR 09 AD	for 1 D-sub insert 9 poles (not included)
CR 15 AD	for 1 D-sub insert 15 poles (not included)
CR 25 AD	for 1 D-sub insert 25 poles (not included)

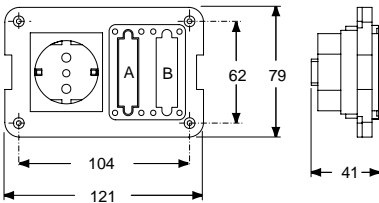

Closed seat "A" for use with one insert only.
The closing is achieved by means of a plastic membrane that can easily be removed if the second seat is required.

CR.. AD plates to be ordered separately

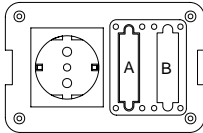
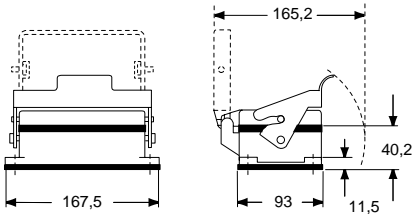

housing panel cut-out

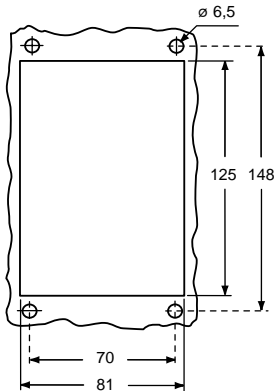

CRH - CRZ closure and reduction plate

enclosures

size "44.27"	from page 387
size "57.27"	from page 393
size "77.27"	from page 402
size "104.27"	from page 412

"104.27" closure plate

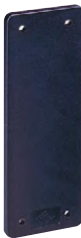

"104.27" reduction plate



description

part No.

part No.

in self-extinguishing thermoplastic resin
with gasket in vinyl-nitrile elastomer

CRH 24

in self-extinguishing thermoplastic resin
with gasket in vinyl-nitrile elastomer
for bulkhead mounting housings ¹⁾ size "44.27"
for bulkhead mounting housings ¹⁾ size "57.27"
for bulkhead mounting housings ¹⁾ size "77.27"
for bulkhead mounting housings ¹⁾ size "104.27"

CRZ 06
CRZ 10
CRZ 16
CRZ 24

¹⁾ Cannot be used with T-TYPE series and
IP68 CG/MG series

CRH 24

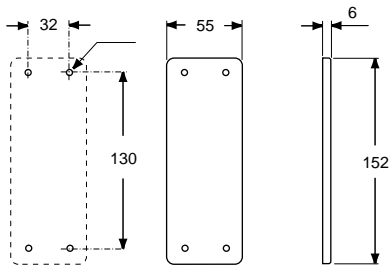

CRZ

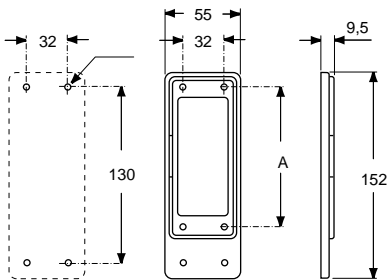

CRZ	A
06	44
10	44
16	57
24	77,5