

RINGKABELSCHUH

Quetschkabelschuh KSE-RK

Passende Werkzeuge
siehe GOGATOOL

ähnlich DIN 46234
nach VG 88710

GOGATEC Handelsges.m.b.H
Wagramer Straße 252
A-1220 Wien
Tel.: +43 1 258 3 257 0
Fax: +43 1 258 3 257 17
office@gogatec.com
www.gogatec.com

Wir liefern sicher

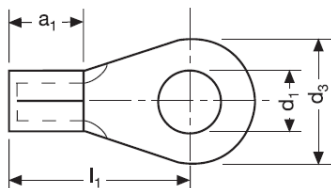

mm ²	Loch für	Abmessungen					Gewicht 100 Stk.	VPE	Typ	Art.Nr.	EURO 100Stk
		d1	d3	l1	a1	s					
10	M4	4,3	8	14	8	1,1	0,200	500	KSE-RK-10-M4	123010010004	12,81
	M5	5,3	10	16	8	1,1	0,225		KSE-RK-10-M5	123010010005	10,87
	M6	6,5	11	17	8	1,1	0,240		KSE-RK-10-M6	123010010006	10,35
	M8	8,4	14	20	8	1,1	0,290		KSE-RK-10-M8	123010010008	12,34
	M10	10,5	18	21	8	1,1	0,340		KSE-RK-10-M10	123010010010	14,97
	M12	13,0	22	23	8	1,1	0,420		KSE-RK-10-M12	123010010012	17,78
16	M5	5,3	11	20	10	1,2	0,390	200	KSE-RK-16-M5	123010016005	14,81
	M6	6,5	11	20	10	1,2	0,380		KSE-RK-16-M6	123010016006	16,15
	M8	8,4	14	22	10	1,2	0,430		KSE-RK-16-M8	123010016008	20,11
	M10	10,5	18	24	10	1,2	0,500		KSE-RK-16-M10	123010016010	21,98
	M12	13,0	22	26	10	1,2	0,580		KSE-RK-16-M12	123010016012	27,78
25	M5	5,3	12	25	11	1,5	0,750	100	KSE-RK-25-M5	123010025005	32,06
	M6	6,5	12	25	11	1,5	0,760		KSE-RK-25-M6	123010025006	31,58
	M8	8,4	16	25	11	1,5	0,790		KSE-RK-25-M8	123010025008	33,05
	M10	10,5	18	26	11	1,5	0,800		KSE-RK-25-M10	123010025010	35,49
	M12	13,0	31	31	11	1,5	0,920		KSE-RK-25-M12	123010025012	42,00
	M16	17,0	36	36	11	1,5	1,320		KSE-RK-25-M16	123010025016	58,50
35	M6	6,5	15	26	12	1,6	1,010	100	KSE-RK-35-M6	123010035006	41,93
	M8	8,4	16	26	12	1,6	0,980		KSE-RK-35-M8	123010035008	41,45
	M10	10,5	18	27	12	1,6	1,000		KSE-RK-35-M10	123010035010	43,42
	M12	13,0	22	31	12	1,6	1,260		KSE-RK-35-M12	123010035012	52,20
	M16	17,0	28	36	12	1,6	1,550		KSE-RK-35-M16	123010035016	61,80
50	M6	6,5	18	34	16	1,8	1,650	100	KSE-RK-50-M6	123010050006	65,60
	M8	8,4	18	34	16	1,8	1,650		KSE-RK-50-M8	123010050008	70,70
	M10	10,5	18	34	16	1,8	1,600		KSE-RK-50-M10	123010050010	64,70
	M12	13,0	22	36	16	1,8	1,800		KSE-RK-50-M12	123010050012	76,60
	M16	17,0	28	40	16	1,8	2,100		KSE-RK-50-M16	123010050016	101,00
70	M6	6,5	22	38	18	2,0	2,700	100	KSE-RK-70-M6	123010070006	93,60
	M8	8,4	22	38	18	2,0	2,600		KSE-RK-70-M8	123010070008	93,60
	M10	10,5	22	38	18	2,0	2,560		KSE-RK-70-M10	123010070010	93,60
	M12	13,0	22	38	18	2,0	2,400		KSE-RK-70-M12	123010070012	93,60
	M16	17,0	28	42	18	2,0	2,700		KSE-RK-70-M16	123010070016	110,60

a.A. auf Anfrage

GOGAPIN KSE

Ringkabelschuhe, Kerbverbinder

Made in
Germany



Fortsetzung

Passende Werkzeuge
siehe GOGATOOL

RINGKABELSCHUH

Quetschkabelschuh KSE-RK

ähnlich DIN 46234
nach VG 88710

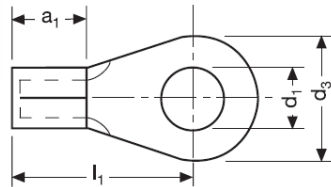

GOGATEC Handelsges.m.b.H
Wagramer Straße 252
A-1220 Wien
Tel.: +43 1 258 3 257 0
Fax: +43 1 258 3 257 17
office@gogatec.com
www.gogatec.com

Wir liefern sicher

mm ²	Loch für	Abmessungen					Gewicht 100 Stk.	VPE	Typ	Art.Nr.	EURO 100Stk
		d1	d3	l1	a1	s					
95	M8	8,4	24	42	20	2,5	4,300	100	KSE-RK-95-M8	123010095008	173,00
	M10	10,5	24	42	20	2,5	4,100		KSE-RK-95-M10	123010095010	173,00
	M12	13,0	24	42	20	2,5	3,900		KSE-RK-95-M12	123010095012	173,00
	M16	17,0	28	44	20	2,5	4,100		KSE-RK-95-M16	123010095016	188,00
120	M8	8,4	24	44	22	3,0	5,700	50	KSE-RK-120-M8	123010120008	215,00
	M10	10,5	24	44	22	3,0	5,600		KSE-RK-120-M10	123010120010	219,00
	M12	13,0	24	44	22	3,0	5,400		KSE-RK-120-M12	123010120012	219,00
	M16	17,0	28	48	22	3,0	5,800		KSE-RK-120-M16	123010120016	237,00
150	M10	10,5	30	50	24	3,2	7,600	25	KSE-RK-150-M10	123010150010	303,00
	M12	13,0	30	50	24	3,2	7,600		KSE-RK-150-M12	123010150012	320,00
	M16	17,0	30	50	24	3,2	7,500		KSE-RK-150-M16	123010150016	350,00
185	M10	10,5	36	50	28	3,5	10,120	20	KSE-RK-185-M10	123010185010	547,00
	M12	13,0	36	50	28	3,5	10,120		KSE-RK-185-M12	123010185012	547,00
	M16	17,0	36	50	28	3,5	10,120		KSE-RK-185-M16	123010185016	547,00
240	M10	10,5	38	56	32	4,0	15,530	15	KSE-RK-240-M10	123010240010	699,00
	M12	13,0	38	56	32	4,0	14,820		KSE-RK-240-M12	123010240012	698,00
	M16	17,0	38	56	32	4,0	14,350		KSE-RK-240-M16	123010240016	a.A.
300	M10	10,5	50	69	35	4,5	20,000	10	KSE-RK-300-M10	123010300010	a.A.
	M12	13,0	50	69	35	4,5	20,000		KSE-RK-300-M12	123010300012	a.A.
	M16	17,0	50	69	35	4,5	20,000		KSE-RK-300-M16	123010300016	1185,00

a.A. auf Anfrage

KERBVERBINDER KSE-KV

mm ²	Gewicht 100 Stk.	Abmessung in mm				VPE	ohne Inspektionsloch		EURO 100Stk
		d4	l1	d1	s		Typ	Art.Nr.	
10	0,600	5,0	30,0	8,0	1,1	500	KSE-KV-10	1230850100	49,09
16	1,020	6,0	35,0	9,0	1,2	500	KSE-KV-16	1230850160	66,80
25	1,430	7,0	40,0	10,0	1,5	100	KSE-KV-25	1230850250	97,40
35	2,250	8,5	45,0	12,0	1,6	100	KSE-KV-35	1230850350	102,90
50	3,380	10,0	55,0	14,0	1,8	100	KSE-KV-50	1230850500	151,00
70	4,900	12,0	55,0	16,0	2,0	100	KSE-KV-70	1230850700	176,00
95	6,000	13,5	60,0	18,0	2,5	50	KSE-KV-95	1230850950	209,00
120	9,100	15,0	65,0	20,0	3,0	50	KSE-KV-120	1230851200	250,00
150	12,300	17,0	70,0	22,0	3,2	50	KSE-KV-150	1230851500	301,00
185	12,500	19,0	75,0	24,0	3,2	25	KSE-KV-185	1230851850	366,00
240	13,900	21,0	85,0	26,0	3,2	25	KSE-KV-240	1230852400	384,00
300	22,000	24,0	100,0	30,0	3,5	25	KSE-KV-300	1230853000	544,00

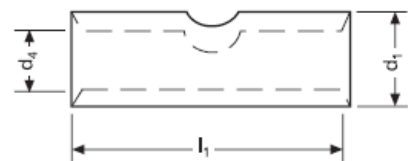

Preise gültig ab 1.3.2009 exkl. MWSt., freibleibend, Auftragsrabatt auf Anfrage
Sonst. Konditionen siehe www.gogatec.com/AGB.pdf, techn. Änderungen vorbehalten

GABELKABELSCHUH Quetschkabelschuh KSE-GK

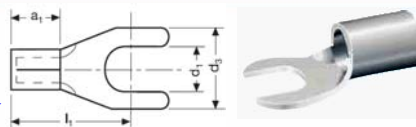

mm ²	Loch für	kg /100	Abmessung in mm					VPE	Typ	Art.Nr.	EURO 100Stk
			d1	d3	l1	a1	s				
10	M5	0,225	5,3	10,5	17,0	8,0	1,1	500	KSE-GK-10-M5	123020010005	12,63
	M6	0,240	6,4	10,5	17,0	8,0	1,1		KSE-GK-10-M6	123020010006	17,96
16	M5	0,390	5,3	11,0	20,0	10,0	1,2	500	KSE-GK-16-M5	123020016005	18,75
	M6	0,380	6,4	11,0	20,0	10,0	1,2		KSE-GK-16-M6	123020016006	24,86
25	M5	0,750	5,3	12,0	25,0	11,0	1,5	500	KSE-GK-25-M5	123020025005	39,06
	M6	0,760	6,4	12,0	25,0	11,0	1,5		KSE-GK-25-M6	123020025006	39,06

GOGATEC Handelsges.m.b.H
Wagramer Straße 252
A-1220 Wien
Tel.: +43 1 258 3 257 0
Fax: +43 1 258 3 257 17
office@gogatec.com
www.gogatec.com

Wir liefern sicher

STIFTKABELSCHUH Quetschkabelschuh KSE-SK

mm ²	Gewicht 100 Stk.	Abmessung in mm					VPE	Typ	Art.Nr.	EURO 100Stk
		d3	d4	l1	a3	s				
10	0,260	4,3	4,5	25,0	10,0	1,1	500	KSE-SK-10	123030010	13,13
16	0,440	5,5	5,8	26,0	12,0	1,2	500	KSE-SK-16	123030016	24,15
25	0,630	7,0	7,0	33,0	14,0	1,2	500	KSE-SK-25	123030025	52,50
35	1,170	8,0	8,2	40,0	16,0	1,5	250	KSE-SK-35	123030035	59,10
50	1,790	9,5	9,5	45,0	19,0	1,8	150	KSE-SK-50	123030050	63,00
70	2,920	11,0	11,2	55,0	24,0	2,0	75	KSE-SK-70	123030070	107,70
95	4,300	12,5	13,5	55,0	24,0	2,5	60	KSE-SK-95	123030095	183,00

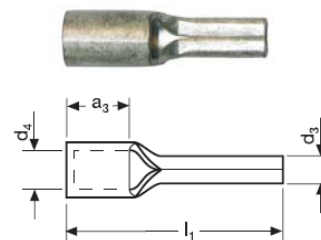

LÖTKABELSCHUH Ringkabelschuh KSL-RK

Ringform DIN 46211 Form A

mm ²	Loch für	Gewicht 100 Stk.	Abmessung in mm				VPE	Typ	Art.Nr.	EURO 100Stk
			d1	d3	l1	a1				
10	M5	0,300	5,3	10,0	19,0	10,0	1000	KSL-RK-10-M5	122010010005	62,50
	M6	0,310	6,5	11,0	21,0	10,0		KSL-RK-10-M6	122010010006	33,50
	M8	0,400	8,4	15,0	24,0	10,0		KSL-RK-10-M8	122010010008	a.A
	M10	0,490	10,5	19,0	26,0	10,0		KSL-RK-10-M10	122010010010	110,90
16	M6	0,510	6,5	11,0	24,0	11,5	500	KSL-RK-16-M6	122010016006	67,60
	M8	0,610	8,4	15,0	27,0	11,5		KSL-RK-16-M8	122010016008	59,90
	M10	0,730	10,5	19,0	29,0	11,5		KSL-RK-16-M10	122010016010	75,50
	M12	0,850	13,0	22,0	31,0	11,5		KSL-RK-16-M12	122010016012	90,60
25	M6	0,900	6,5	13,0	27,0	13,5	300	KSL-RK-25-M6	122010025006	a.A
	M8	1,000	8,4	15,0	30,0	13,5		KSL-RK-25-M8	122010025008	80,00
	M10	1,110	10,5	19,0	32,0	13,5		KSL-RK-25-M10	122010025010	379,00
	M12	1,250	13,0	22,0	35,0	13,5		KSL-RK-25-M12	122010025012	116,60
35	M8	1,450	8,4	15,0	33,0	16,0	150	KSL-RK-35-M8	122010035008	135,50
	M10	1,570	10,5	19,0	35,0	16,0		KSL-RK-35-M10	122010035010	138,90
	M12	1,740	13,0	22,0	38,0	16,0		KSL-RK-35-M12	122010035012	174,00
50	M8	2,360	8,4	17,0	36,0	19,0	100	KSL-RK-50-M8	122010050008	202,00
	M10	2,450	10,5	19,0	38,0	19,0		KSL-RK-50-M10	122010050010	213,00
	M12	2,670	13,0	22,0	41,0	19,0		KSL-RK-50-M12	122010050012	645,00
70	M10	4,250	10,5	21,0	44,0	24,0	50	KSL-RK-70-M10	122010070010	345,00
	M12	4,380	13,0	22,0	47,0	24,0		KSL-RK-70-M12	122010070012	357,00
95	M10	5,440	10,5	21,0	44,0	24,0	40	KSL-RK-95-M10	122010095010	673,00
	M12	5,540	13,0	22,0	47,0	24,0		KSL-RK-95-M12	123010095012	582,00

Passende Werkzeuge
siehe GOGATOOL

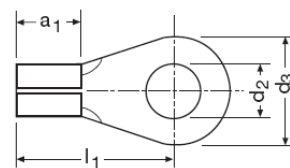

a.A. auf Anfrage

Preise gültig ab 1.3.2009 exkl. MWSt., Lötkaabelschuhe exkl. MTZ, freibleibend, Auftragsrabatt auf Anfrage
Sonst. Konditionen siehe www.gogatec.com/AGB.pdf, techn. Änderungen vorbehalten