

Explosionsafe signaltower Ø 40mm with sealed cable

On special request available:
An open-collector version
enabling direct drive by a PLC.

The ingress protection degree
IP 65 makes the signaltower
suitable for installation in
damp locations, **dusty** factories
and **outdoor** environments

[description]

Explosion safe signaltower featuring
a LED type that is versatile and
energy-efficient.

The combination of vertical and
horizontal cuttings at lenses and a
double reflection system enhances
the LED light diffusion to create
a unique, full and brilliant light.
The lenses and main body are
made of synthetic materials with
strong characteristics against harsh
environments.

The signaltower can be ordered as
desired with 1 to 5 lighting modules
equipped with different light colours.
Alternative to the version “continuous
light” the signaltower can also be
ordered with selectable flashing /
continuous light and with two super
loud alarms with 85 dB output.
The ingress protection of this version
will be limited to IP 54.



[features]

- Explosionsafe for gas and dust
- Suitable for zone 2 and zone 22
- CE in accordance with ATEX
- Full and brilliant signal
- Lighting by double reflection LED system
- 1 to 5 lights
- Available as ‘continuous light’ or ‘continuous / flashing + two audible alarms’
- Ingress protection IP 65
- Lens with different colours
- Wall or direct mounting

CE ATEX  II 3GD
Ex nA II T4

[dimensions]

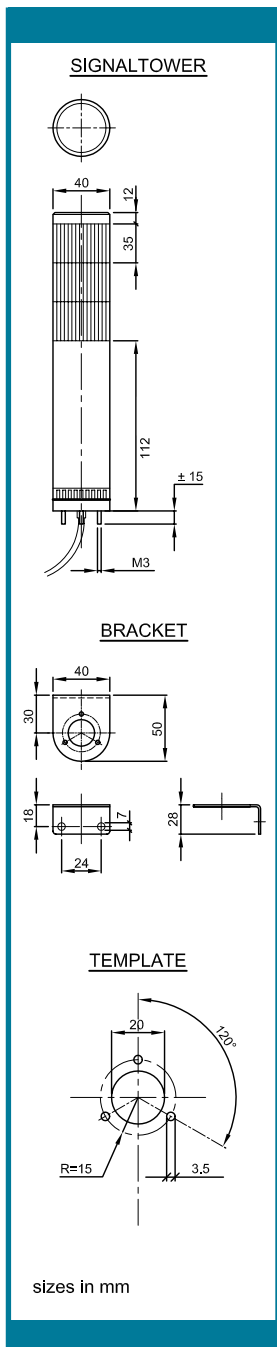

[technical data]

Explosionsafety:	CE Ⓜ II 3 GD; Ex nA II T4; Ex tD A22 IP65 T85°C
Applicable EU directives:	94/9/EG (ATEX) and 89/336 (EMC)
CE conformity:	EN 60079-0, EN 60079-15, EN 61241-0, EN 61241-1
Certification:	EC-Declaration of conformity (ARTIDOR)
Ambient temperature:	-20 °C to +40 °C
Ingress protection:	IP65 (AR-070/011) IP54 (AR-070/021) to EN 60529
Material:	ABS towerbody, polyester glassfibre reinforced base
Lighting source:	Multiple LED's with double reflection system
Acoustical source:	Buzzer 85 dB (1m) with two different tones
Voltage:	24 V AC/DC
Assembly position:	As desired
Activation time:	100%
Light colours available:	Red, Amber, Green, Blue, Clear
Connection cable:	Factory sealed cable, Ø 8 mm, length 1.5 metres

CURRENTS			
LED		BUZZER	
Signal Line Current		Signal Line Current	Rush in Current
Red, Orange	Green, Blue, Clear	40 mA	250 mA
30 mA	25 mA		

CONNECTION DIAGRAMS

continuous light AC/DC 24V

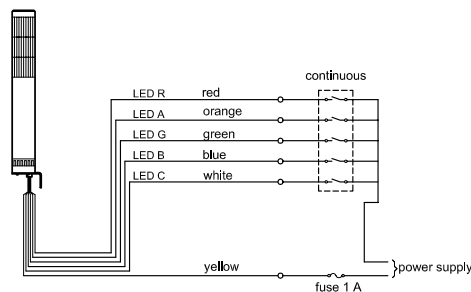

continuous and flashing light with alarm AC/DC 24V

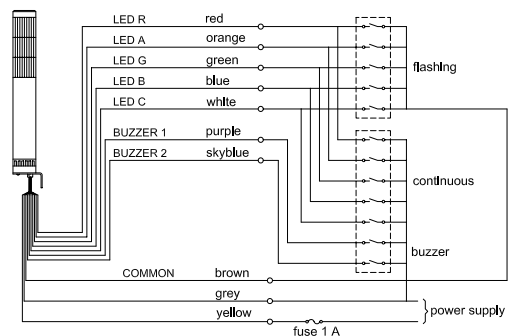

[ordering code]

EXPLOSIONSAFE SIGNAL TOWER					
Version	Code	Voltage	Code	Number of stacks	Code
Continuous light (only)	1	24 V AC/DC	1	1	1
Continuous / Flashing light and two Audible alarms	2			2	2
				3	3
				4	4
				5	5

→ Type number AR 070 - 0 1 /

Subject to change without notice. Issue June 2011

PATLITE Corporation

International Division
8-8, Matsuyamachi, Chuo-ku, Osaka, Japan 542-0067 TEL.+81-6-6763-8220 FAX.+81-6-6763-8221
PATLITE (U.S.A.) Corporation
20130 S. Western Ave., Torrance, CA 90501, U.S.A TEL.+1-310-328-3222 FAX.+1-310-328-2676
PATLITE Europe GmbH
Am Soeldnermoos 8, D-85399 Hallbergmoos, Germany TEL.+49-811 9981 9770-0 FAX.+49-811 9981 9770-9

PATLITE (SINGAPORE) PTE LTD
No.2 Leng Kee Road, #05-01 Thye Hong Centre, Singapore 159086 TEL.+65-6226-1111 FAX.+65-6324-1411
PATLITE (CHINA) Corporation
Room 512, Juleng Business Building, No.667-3 Linghai Road, Shanghai, China 200072 TEL.+86-21-6630-8969 FAX.+86-21-6630-8938
PATLITE KOREA CO., LTD.
202 Seokwang Bldg. 1381-9 Seocho-dong, Seocho-gu, Seoul, 137-863 Korea TEL.+82-2-523-6636 FAX.+82-2-523-6637

Explosionsafe signaltower Ø 60mm with sealed cable

On special request available:
An open-collector version
enabling direct drive by a PLC.

The ingress protection degree
IP 65 makes the signaltower
suitable for installation in **damp**
locations, **dusty** factories and
outdoor environments.

[description]

Explosionsafe signaltower featuring a
LED type that is versatile and energy-
efficient.

The combination of vertical and
horizontal cuttings at lenses and a
double reflection system enhances
the LED light diffusion to create
a unique, full and brilliant light.
The lenses and main body are
made of synthetic materials with
strong characteristics against harsh
environments.

The signaltower can be ordered as
desired with 1 to 5 lighting modules
equipped with different light colours.
Alternative to the version "continuous
light" the signaltower can also be
ordered with selectable flashing /
continous light and with two super
loud alarms with 85 dB output.
The ingress protection of this version
will be limited to IP 54.

PATLITE

New Frontiers in Safety, Security and Comfort.



[features]

- Explosionsafe for gas and dust
- Suitable for zone 2 and zone 22
- CE in accordance with ATEX
- Full and brilliant signal
- Lighting by double reflection
LED system
- 1 to 5 lights
- Available as 'continuous light' or
'continuous / flashing + two
audible alarms'
- Ingress protection IP 65
- Lens with different colours
- Wall or direct mounting

CE ATEX  II 3GD
Ex nA II T4

dimensions

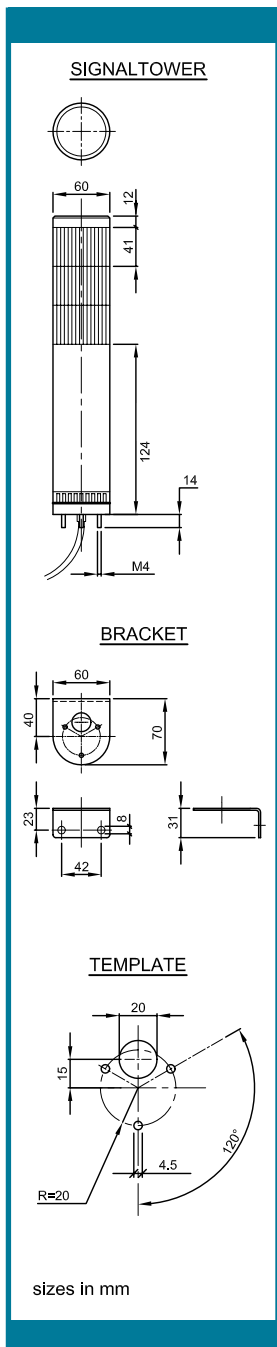

technical data

Explosionsafety:	CE Ex II 3 GD; Ex nA II T4; Ex tD A22 IP65 T85°C
Applicable EU directives:	94/9/EG (ATEX) and 89/336 (EMC)
CE conformance:	EN 60079-0, EN 60079-15, EN 61241-0, EN 61241-1
Certification:	EC-Declaration of conformity (ARTIDOR)
Ambient temperature:	-20 °C to +40 °C
Ingress protection:	IP65 (AR-078/011) IP54 (AR-078/021) to EN 60529
Material:	ABS towerbody, polyester glassfibre reinforced base
Lighting source:	Multiple LED's with double reflection system
Acoustical source:	Buzzer 85 dB (1m) with two different tones
Voltages:	24 V AC/DC
Assembly position:	As desired
Activation time:	100%
Light colours available:	Red, Amber, Green, Blue, Clear
Connection cable:	Factory sealed cable, \varnothing 8 mm, length 1.5 metres

CURRENTS

LED		Buzzer	
Signal Line Current		Signal Line Current	Rush in Current
Red, Orange	Green, Blue, Clear	40 mA	250 mA
50 mA	20 mA		

CONNECTION DIAGRAMS

continuous light AC/DC 24V

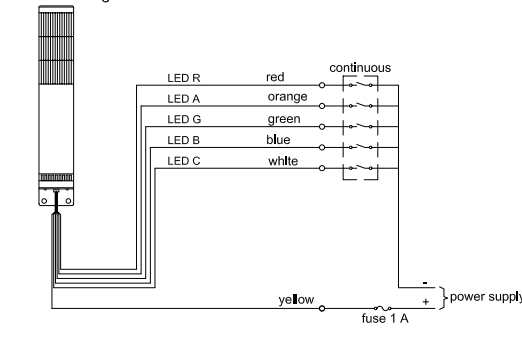

continuous and flashing light with alarm AC/DC 24V

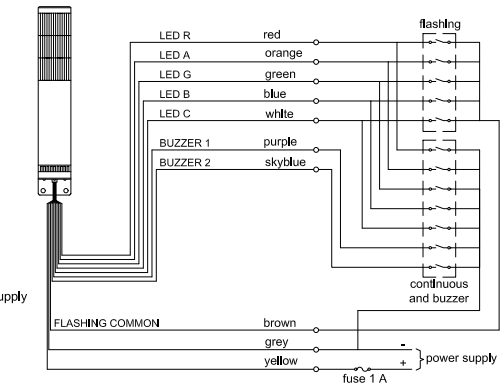

ordering code

EXPLOSIONSAFE SIGNAL TOWER					
Version	Code	Voltage	Code	Number of stacks	Code
Continuous light (only)	1	24 V AC/DC	1	1	1
Continuous / Flashing light and two Audible alarms	2			2	2
				3	3
				4	4
				5	5

→ Type number AR 078 - 0 1 /

PATLITE Corporation

International Division
8-8, Matsuyamachi, Chuo-ku, Osaka, Japan 542-0067 TEL.+81-6-6763-8220 FAX.+81-6-6763-8221

PATLITE (U.S.A.) Corporation
20130 S. Western Ave., Torrance, CA 90501, U.S.A TEL.+1-310-328-3222 FAX.+1-310-328-2676

PATLITE Europe GmbH
Am Soeldnermoos 8, D-85399 Hallbergmoos, Germany TEL.+49-811 9981 9770-0 FAX.+49-811 9981 9770-9

PATLITE (SINGAPORE) PTE LTD
No 2 Leng Kee Road, #05-01 Thye Hong Centre, Singapore 159086 TEL.+65-6226-1111 FAX.+65-6324-1411

PATLITE (CHINA) Corporation
Room 512, Juleng Business Building, No 691-3 Lingshi Road, Shanghai China 200072 TEL.+86-21-6630-8969 FAX.+86-21-6630-8938

PATLITE KOREA CO., LTD.
202 Seokwang Bldg, 1361-9 Seocho-dong, Seocho-gu, Seoul, 137-863 Korea TEL.+82-2-523-6636 FAX.+82-2-523-6637