

MIXO FRAMES

Made of die-cast zinc alloy
with protective earth (PE) contacts

SUM UP

- ☐ Die-cast zinc alloy frames
- ☐ Protective earth (PE)
- ☐ Possibility of mounting female and male modular units on the same frame
- ☐ Polarisation on frames
- ☐ When two or more identical connectors of the MIXO series are used, use of coding pins (CR...CX series) may prevent incorrect coupling

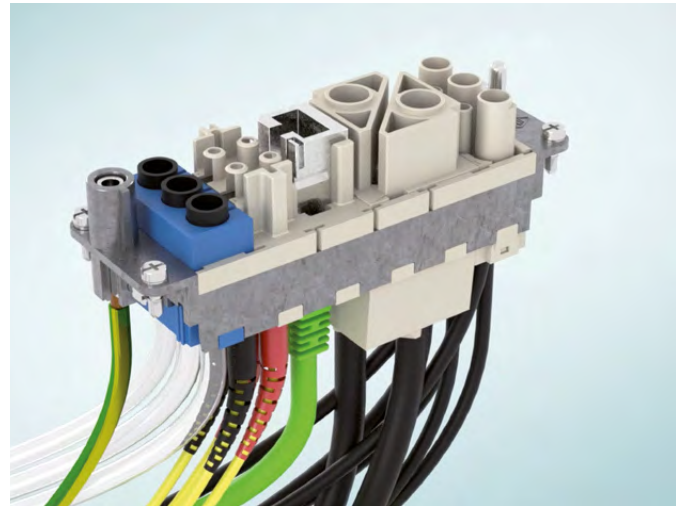

TECHNICAL FEATURES

MIXO FRAMES

HOW TO SELECT FRAMES

- 1 **Calculate** the number of frame slots taken up by the required inserts (frame slot 1, 2 or 3 modules).



	No. of frame slots
CX 01 9VF/M	1
CX 01 9VTF	1
CX 01 GF/M	1
CX 01 J8	1
CX 01 UF/M	1
CX 02 4AF/M	1
CX 02 4BF/M	1
CX 02 4F/M	1
CX 02 7F/M	1
CX 02 CHF/M	1
CX 02 P	1
CX 03 4F/M	1
CX 03 4BF/M	1
CX 03 P	1
CX 3/4 XDF/M	1
CX 04 LF/M	1
CX 04 RF/M	1
CX 04 SCF/M	1
CX 04 XF/M	1
CX 05 SF/M	1
CX 05 SHF/M	1
CX 06 CF/M	1
CX 06P CF/M	1
CX 08 CF/M	1
CX 08 I6F/M	1
CX 12 DF/M	1
CX 17 DF/M	1
CX 25 IBF/M	1
CX 25 IF/M	1
CX FM	1



	No. of frame slots
CX 01 JF/M	2
CX 01 YF/M	2
CX 01 YPEF/M	2
CX 02 BF/M	2
CX 02 GF/M	2
CX 02 HF/M	2
CX 20 CF/M	2
CX 42 DF/M	2

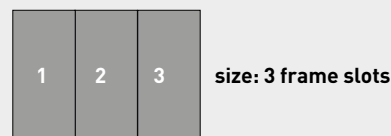

	No. of frame slots
CX 02 JF/M	3

- 2 **Select** the right frame according to the number of required modules (available 1, 2, 3, 4 and 6 modules).

CX 01 T
1 module



CX 02 TF/TM
2 modules



CX 03 TF/TM
3 modules



CX 04 TF/TM
4 modules



CX 06 TF/TM
6 modules

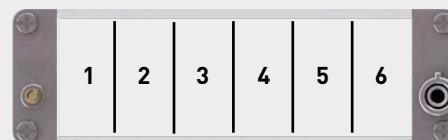

- Fill the unused frame slots with CX FM dummy module



Possibility to use the MIXO **HNM frames** (provided with special gold plated PE contacts) together with R series of crimp contacts and the relevant connector hoods and housings, to produce where

required an **HNM** connector (High Number of Matings, up to 10.000 cycles of operation).

CX 01 T

enclosures: size "49.16"	page:
IL-BRID	374 - 377, 382
CZ7 IP67, single lever	384
W-TYPE for aggressive environments	519
E-Xtreme® corrosion proof	540
EMC	576
panel supports: COB + adaptor	page: 652 - 654

frames for modular units



description

part No.

for CZ enclosures

CX 01 T

- die-cast zinc alloy frames
- protective earth (PE)
- polarisation on frames
- coding pins **CR..CX**

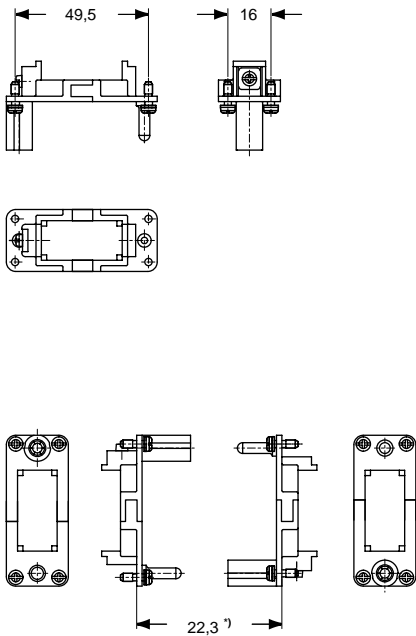

*) distance for electric contacts: max 24 mm
distance for pneumatic contacts: max 23,5 mm

- small earth terminal for cables from 1-2,5 mm²,
AWG 18-14

CX 02 TM/TF, CX 03 TM/TF, CX 04 TM/TF, CX 06 TM/TF

enclosures:	page:
C-TYPE IP65/IP66	387 - 430
C7 IP67	436 - 442
V-TYPE IP65/IP66	444 - 463
BIG hoods	466 - 473
T-TYPE IP65 insulating	480 - 487
T-TYPE / W IP66/IP69 insulating	489 - 492
HYGIENIC T-TYPE / H IP66/IP69	501 - 504
HYGIENIC T-TYPE / C IP66/IP69, -50 °C	506 - 509
W-TYPE for aggressive environments	521 - 526
E-Xtreme® corrosion proof	530-537, 542-547, 550-557
EMC	578 - 581
Central lever	603 - 614
LS-TYPE	618 - 625
IP68	632 - 647
panel supports:	page:
COB	652 - 653

frames for modular units
with lock-in tab (included)

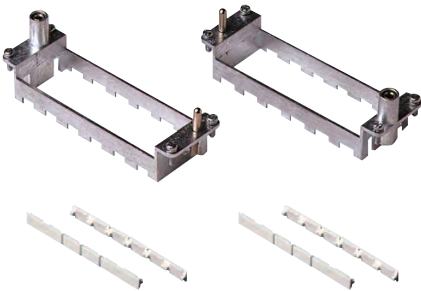

description	part No.
-------------	----------

frames for modular units with lock-in tab included	type for hoods	type for housings
for 2 modular units - for housing size 44.27	CX 02 TM	CX 02 TF
for 3 modular units - for housing size 57.27	CX 03 TM	CX 03 TF
for 4 modular units - for housing size 77.27 and 77.62	CX 04 TM	CX 04 TF
for 6 modular units - for housing size 104.27 and 104.62	CX 06 TM	CX 06 TF

- die-cast zinc alloy frames
- protective earth (PE)
- possibility of mounting female and male modular units on the same frame
- frames supplied with lock-in tab to attach units
- polarisation on frames
- coding pins **CR..CX**
- for spare lock-in tab **CX CFM** see SPARE SPARTS catalogue

CX TM / TF

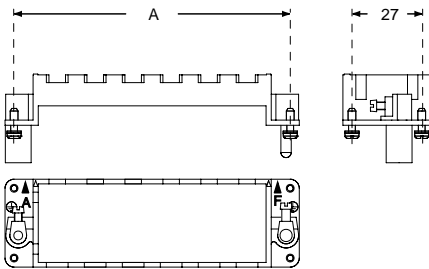

part No.	A (mm)	for housings size
CX 02 TM / TF	44	44.27
CX 03 TM / TF	57	57.27
CX 04 TM / TF	77,5	77.27 and 77.62
CX 06 TM / TF	104	104.27 and 104.62

Earth terminal

- large: for cables from 4-6 mm², AWG 12-10
- small: for cables from 1-2,5 mm², AWG 18-14

☒ In order to accomodate larger PE conductor cross-sectional area, use CGT PE adapters, see page 319.

position of modules (contact side view)

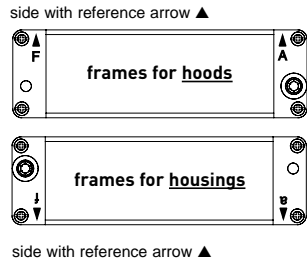

CX CFM (lock-in tab)

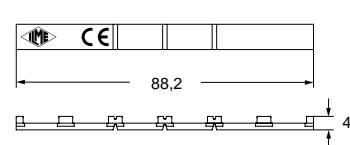

Polarisation of frames with relative identification letters and couplings

frame for hoods ¹⁾ frames for housings ¹⁾

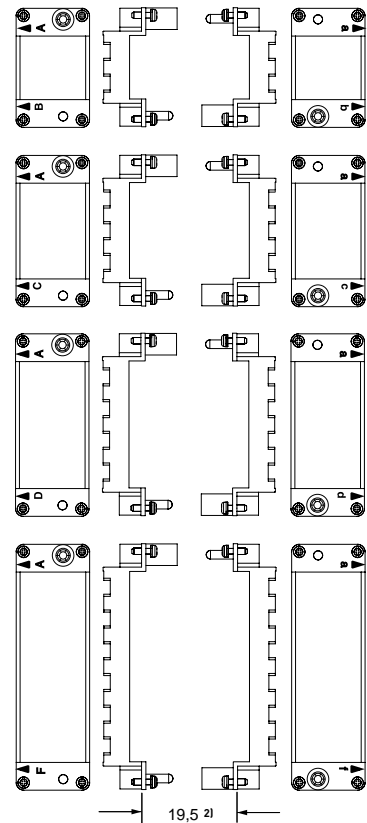

- ¹⁾ **Warning:**
The module support frames are marked:
- FOR HOODS: **upper-case A-B, A-C, A-D and A-F**
- FOR HOUSINGS: **lower-case a-b, a-c, a-d and a-f**
- Positioning the modules in the frames according to the respective letters is ensuring the specular assembly of modules, for which the hood will be coupled correctly to the housing.
- ²⁾ Distance for:
- electric and fibre optic contacts: max 21 mm
- pneumatic contacts: max 20,5 mm

CGT 6.0 – CGT 10 – CGT 16 – CGT 25

PE terminal adapters for MIXO frames

- **PE terminal adapter CGT 6.0** made of nickel plated brass that allows to connect by crimping a 6 mm² / 10 AWG flexible copper conductor **to the small PE terminal** (2,5 mm² / 14 AWG) of a MIXO frame, in case the connector needs a second PE line sized 6 mm²/10 AWG when the large PE terminal (6 mm²/10 AWG) of the MIXO frame is already occupied by a large size PE conductor, by using the existing PE terminal adapter **CGT 16**, or the new ones for the large PE terminal, **CGT 10 or CGT 25**.

CGT 6.0



- **PE terminal adapters CGT 10 and CGT 25** made of nickel plated brass that allow to connect by crimping respectively a 10 mm² / 8 AWG or a 25 mm² / 4 AWG flexible copper conductor **to the large PE terminal** (6 mm²/10 AWG) of a MIXO frame.

CGT 10



- They are offered in addition to the existing PE terminal adapter **CGT 16** for 16 mm² / 6 AWG protective earth conductor – introduced with MIXO 100A modules **CX 02 G and CX 01 G** – to give more flexibility for the combination of MIXO 100A and 70A high power modules with **multi-core cables**, that have the PE conductor of the same size of the phase conductors.

- Crimping is achieved by using the already available manual hydraulic crimping tool **CPPZ C** (Cembre HT 45) with hexagonal crimping dies **CGD 10 C** (for **CGT 10** with 10 mm² / 8 AWG and for **CGT 6.0** with 6 mm² / 10 AWG flexible copper conductors) and **CGD 25 C** (for **CGT 25** with 25 mm² / 4 AWG flexible copper conductors).

CGT 16

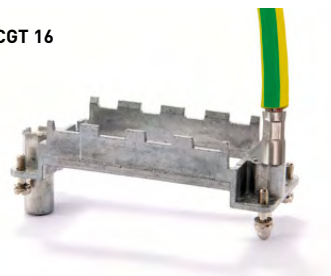

CGT 25

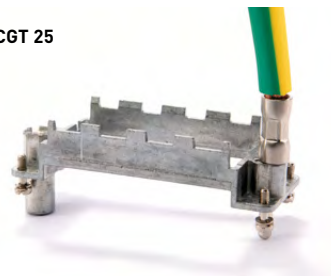



CGT 6.0 - CGT 10 - CGT 16 - CGT 25

The modular inserts must be installed in suitable frames, which are then mounted in traditional enclosures or in COB panel supports.

page:
frames for modular units 316 - 317

PE terminal adapter

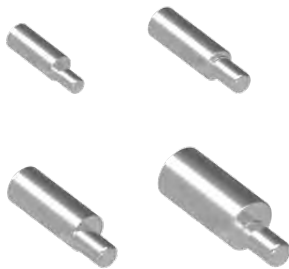

headless screw M4X6



description	part No.	part No.
PE wire terminal adapter 6 mm² (10 AWG)	CGT 6.0	
PE wire terminal adapter 10 mm² (8 AWG)	CGT 10	
PE wire terminal adapter 16 mm² (6 AWG)	CGT 16	
PE wire terminal adapter 25 mm² (4 AWG)	CGT 25	
headless screw M4X6, stainless steel, kit of 10 pcs. (see point 5 below)		CR VGM4

How to use the PE terminal adapter

- 1) Strip 15 mm of flexible PE wire.
- 2) Crimp the cable on the CGT adapter by using the CPPZ C pliers with the dies as follows:
 - CGD 10 C for 6 mm² and 10 mm²
 - CGD 16 C for 16 mm²
 - CGD 25 C for 25 mm²
- 3) Fix the adapter tip in the larger earth terminal (6 mm²) for CGT 10, CGT 16, CGT 25 or in the smaller earth terminal (2,5 mm²) for CGT 6.0 of frames CX...TM/TF.
- 4) To be used with bulkhead mounting housings or high construction hoods.
- 5) Cannot be used with T-TYPE surface mounting housings and horizontal cable outlet hoods.
For the use within bulkhead housings and vertical entry hoods it is needed to replace the M4 screw of the 6 mm² PE contact of the frame with the headless screw **CR VGM4**.

CGT 6.0

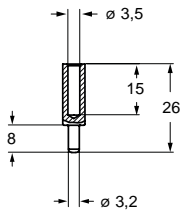

CGT 10

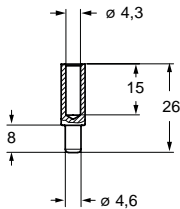

CGT 16

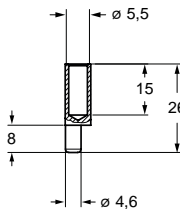

CGT 25

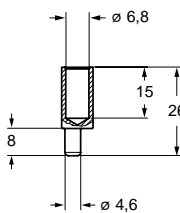

cURus pending



CX FM

The modular inserts must be installed in suitable frames, which are then mounted in traditional enclosures or in COB panel supports.
Alternatively, individual modules with a width of 14,7 mm can be installed in plastic supports.

frames for modular units

page:
316

dummy module



description

part No.

dummy module for unused frame seats

CX FM

Remark:
The new version is formed by a single piece and has a reduced height.
It allows the mating of a MIXO insert including it with a corresponding MIXO insert even having - in front of the dummy module - a regular male or female module equipped with contacts, which obviously will not work. The sole exceptions to this feature are that an insert with this dummy module cannot mate an insert showing in front a CX 3/4 XDF/M, CX 04 XF/M or CX 02 HF module.

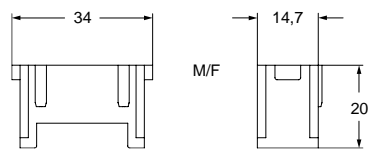

- 1 frame slot

Enclosures

MIXO A-F frame for hoods

MIXO units

MIXO ONE

CZ IL-BRID

C-TYPE

C7 IP68

V-TYPE

T-TYPE

W-TYPE

EMC

LS-TYPE

COB

IP68

Central lever

BIG



CX 01 T



CX 02 TM



CX 03 TM



CX 04 TM



CX 06 TM

RJ45 male crimp plug



CX 01 J8M + CX 8 J6M

RJ45 male IDC plug



CX 01 J8IM + CX 8 J6IM

1x RJ45 male crimp plug
+ 4x 10A crimp contacts



CX 01 JM +
CX 4 JM
(4 data contacts) or
CX 8 JM
(8 data contacts) or
CX 4/2 JM
(4 data + 2 power contacts) or
CX 6/2 JM
(6 data + 2 power contacts) or
CX 4E JM
(4 data cont. cat.5e PROFINET)

2x RJ45 male crimp plug
+ 8x 10A crimp contacts



CX 02 JM +
2x CX 4 JM
(4 data contacts) or
2x CX 8 JM
(8 data contacts) or
2x CX 4/2 JM
(4 data + 2 power contacts) or
2x CX 6/2 JM
(6 data + 2 power contacts) or
2x CX 4E JM
(4 data cont. cat.5e PROFINET)

RJ45 MIXO CONNECTOR Cat 6_A

RJ45 MIXO CONNECTOR Cat 5-5e

MIXO RJ45