



CV - CVA and MV - MVA V-TYPE lever SIMPLEX self-closing covers

inserts		page:
CDD	24 poles + ⊕	76
CDS	9 poles + ⊕	-
CDSH	9 poles + ⊕	86
CDSH NC	6 poles + ⊕	95
CNE	6 poles + ⊕	110
CSE	6 poles + ⊕	-
CSH	6 poles + ⊕	110
CSH S	6 poles + ⊕	122
CCE	6 poles + ⊕	130
CSS	6 poles + ⊕	148
CT, CTSE (16A *)	6 poles + ⊕	160
CQE	10 poles + ⊕	168
MIXO	2 modules	262 - 317

*) can be used only in bulkhead mounting housings

bulkhead mounting housings
with stainless steel single lever



surface mounting housings
with stainless steel single lever



description	part No.	part No.	entry Pg	part No.	entry M
with lever, gasket and cover in plastic	CVI 06 LSP				
with lever and cover		CVP 06 LSP16	16	MVP 06 LSP20	20
with lever and cover, high construction		CVAP 06LSP21	21	MVAP 06LSP25	25
with lever and cover, high construction		CVAP 06LSP29	29	MVAP 06LSP32	32
with lever and cover, high construction				MVAP 06LSP40	40

☑ The enclosures ensure IP65 degree of protection when mated and locked with the closing lever, or IP44 degree of protection when not mated and locked with lever.

panel cut-out for bulkhead mounting housings

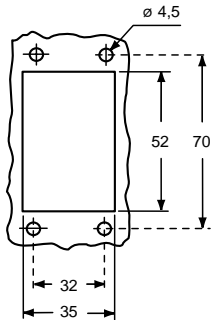

Hoods
(from page 389)



CVI LSP

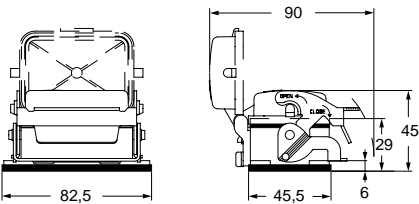

CVP - CVAP LSP and MVP - MVAP LSP

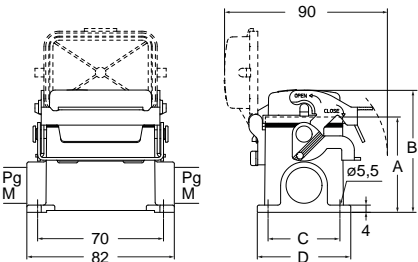

type	A	B	C	D
CVP / MVP 6 LSP	53	68	40	52
CVAP / MVAP 6 LSP	74	89	45	57

CE US Type 4/4X/12



CE US Type 4/4X/12 pending





CV - CVA and MV - MVA V-TYPE lever SIMPLEX self-closing covers

inserts		page:
CDD	42 poles + ⊕	78
CDS	18 poles + ⊕	-
CDSH	18 poles + ⊕	87
CNE	10 poles + ⊕	111
CSE	10 poles + ⊕	-
CSH	10 poles + ⊕	111
CSH S	10 poles + ⊕	123
CCE	10 poles + ⊕	131
CMSH	3+2 (aux) poles + ⊕	136
CMCE	3+2 (aux) poles + ⊕	137
CSS	10 poles + ⊕	149
CT, CTSE (16A) *)	10 poles + ⊕	161
CQE	18 poles + ⊕	169
CX	8/24 poles + ⊕	194
MIXO	3 modules	262 - 317

*) can be used only in bulkhead mounting housings

bulkhead mounting housings
with stainless steel single lever



surface mounting housings
with stainless steel single lever



description	part No.	part No.	entry Pg	part No.	entry M
with lever, gasket and cover in plastic	CVI 10 LSP				
with lever and cover		CVP 10 LSP16	16	MVP 10 LSP20	20
with lever and cover				MVP 10 LSP25	25
with lever and cover, high construction		CVAP 10LSP21	21	MVAP 10LSP25	25
with lever and cover, high construction		CVAP 10LSP29	29	MVAP 10LSP32	32
with lever and cover, high construction				MVAP 10LSP40	40

☑ The enclosures ensure IP65 degree of protection when mated and locked with the closing lever, or IP44 protection when not mated and locked with lever, thanks to the SIMPLEX self-closing cover.

panel cut-out for bulkhead mounting housings

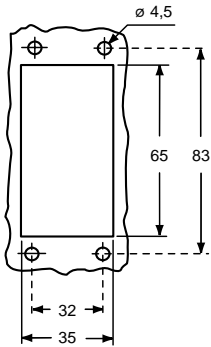

Hoods
(from page 395)



CVI LSP

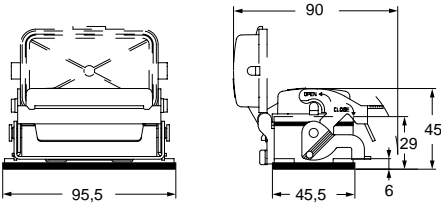

CVP - CVAP LSP and MVP - MVAP LSP

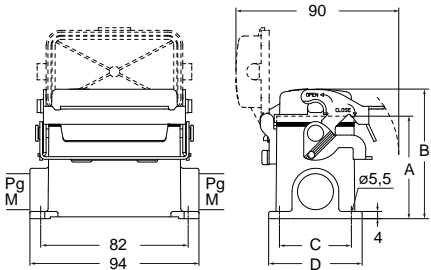

type	A	B	C	D
CVP / MVP 10 LSP	57	72	40	52
CVAP / MVAP 10 LSP	74	89	45	57

CEC® US Type 4/4X/12



CEC® US Type 4/4X/12 pending





CV - CVA and MV - MVA V-TYPE lever SIMPLEX self-closing covers

inserts		page:
CD	40 poles + ⊕	70
CDD	72 poles + ⊕	79
CDS	27 poles + ⊕	-
CDSH	27 poles + ⊕	88
CNE	16 poles + ⊕	112
CSE	16 poles + ⊕	-
CSH	16 poles + ⊕	112
CSH S	16 poles + ⊕	124
CCE	16 poles + ⊕	132
CMSH, CMCE	6+2 (aux) poles + ⊕	138 - 139
CSS	16 poles + ⊕	150
CT, CTS (10A) *)	40 poles + ⊕	156
CT, CTSE (16A) *)	16 poles + ⊕	162
CQE	32 poles + ⊕	170
CQEE	40 poles + ⊕	176
CP	6 poles + ⊕	178
CX	6/12, 6/36 and 12/2 poles + ⊕	197 - 199
CX	4/0 and 4/2 poles + ⊕	200 - 201
MIXO	4 modules	262 - 317

*) can be used only in bulkhead mounting housings

bulkhead mounting housings
with stainless steel single lever



surface mounting housings
with stainless steel single lever



description	part No.	part No.	entry Pg	part No.	entry M
with lever, gasket and cover in plastic	CVI 16 LSP				
with lever and cover		CVP 16 LSP21	21	MVP 16 LSP25	25
with lever and cover, high construction		CVAP 16LSP21	21	MVAP 16LSP25	25
with lever and cover, high construction		CVAP 16LSP29	29	MVAP 16LSP32	32
with lever and cover, high construction				MVAP 16LSP40	40

☑ The enclosures ensure IP65 degree of protection when mated and locked with the closing lever, or IP44 protection when not mated and locked with lever, thanks to the SIMPLEX self-closing cover.

panel cut-out for bulkhead mounting housings

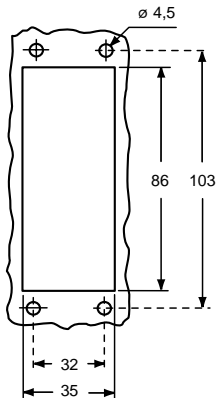

Hoods
(from page 404)



CVI LSP

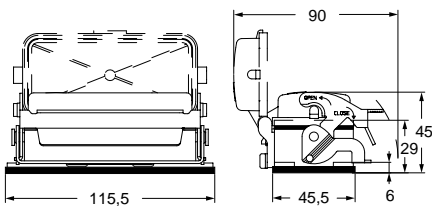

CVP - CVAP LSP and MVP - MVAP LSP

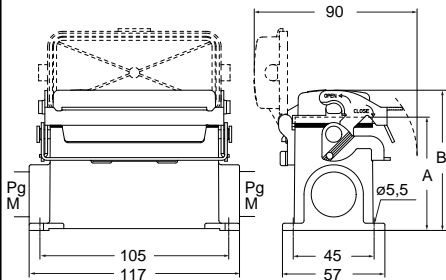

part No.	A	B
CVP / MVP 16 LSP	63	78
CVAP / MVAP 16 LSP	81	96

CAUS Type 4/4X/12



CAUS Type 4/4X/12 pending



CV - CVA and MV - MVA V-TYPE lever SIMPLEX self-closing covers

inserts

CD	64 poles + ⊕	72
CDD	108 poles + ⊕	81
CDS	42 poles + ⊕	-
CDSH	42 poles + ⊕	89
CNE	24 poles + ⊕	113
CSE	24 poles + ⊕	-
CSH	24 poles + ⊕	113
CSH S	24 poles + ⊕	125
CCE	24 poles + ⊕	133
CMSH	10+2 (aux) poles + ⊕	140
CMCE	10+2 (aux) poles + ⊕	141
CSS	24 poles + ⊕	151
CT, CTS (10A) *)	64 poles + ⊕	157
CT, CTSE (16A) *)	24 poles + ⊕	163
CQE	46 poles + ⊕	171
CQEE	64 poles + ⊕	177
CX	4/8 and 6/6 poles + ⊕	204, 206
MIXO	6 modules	262 - 317

*) can be used only in bulkhead mounting housings

page:

bulkhead mounting housings
with stainless steel single leversurface mounting housings
with stainless steel single lever

description	part No.	part No.	entry Pg	part No.	entry M
with lever, gasket and cover in plastic	CVI 24 LSP				
with lever and cover		CVP 24 LSP21	21	MVP 24 LSP25	25
with lever and cover, high construction		CVAP 24LSP21	21	MVAP 24LSP25	25
with lever and cover, high construction		CVAP 24LSP29	29	MVAP 24LSP32	32
with lever and cover, high construction				MVAP 24LSP40	40

☑ The enclosures ensure IP65 degree of protection when mated and locked with the closing lever, or IP44 protection when not mated and locked with lever, thanks to the SIMPLEX self-closing cover.

panel cut-out for bulkhead mounting housings

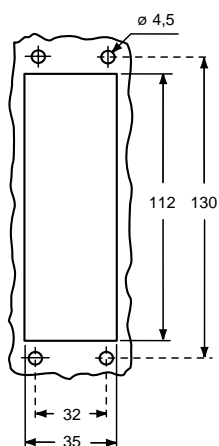

Hoods
(from page 414)



CVI LSP

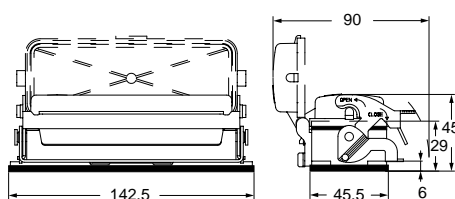

CVP - CVAP LSP and MVP - MVAP LSP

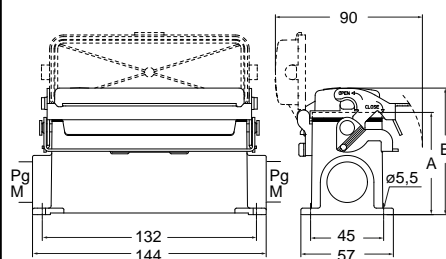

type	A	B
CVP / MVP 24 LSP	63	78
CVAP / MVAP 24 LSP	81	96

CAUS Type
4/4X/12



CAUS Type
4/4X/12
pending

