



CH and MH C-TYPE standard version

inserts		page:
CD	50 poles + ⊕	71
CDD	76 poles + ⊕	80
CDA	32 poles + ⊕	102
CSAH	32 poles + ⊕	103
CDC	32 poles + ⊕	106

insert dimensions:  
2 x (66 x 16) mm

bulkhead mounting housings  
with 2 levers or 4 pegs



surface mounting housings  
with 2 levers or 4 pegs



description	part No.	part No.	entry Pg	part No.	entry M
with levers	CHI 50				
with pegs and cover 1)	CHI 50 CS				
with levers		CHP 50.21	21	MHP 50.32	32
with levers		CHP 50.221	21 x 2	MHP 50.232	32 x 2
with levers		CHP 50.29	29	MHP 50.40	40
with levers		CHP 50.229	29 x 2	MHP 50.240	40 x 2
with pegs and cover 1)		CHP 50 CS	21	MHP 50 CS32	32
with pegs and cover 1)		CHP 50 CS2	21 x 2	MHP 50 CS232	32 x 2
with pegs and cover 1)		CHP 50 CS29	29	MHP 50 CS40	40
with pegs and cover 1)		CHP 50 CS229	29 x 2	MHP 50 CS240	40 x 2

1) may be combined with enclosures:  
- CHO/CAO 50 X and CAV 50 X  
- MHO/MAO/MFO 50 X and MAV/MFV 50 X

panel cut-out for bulkhead mounting housings

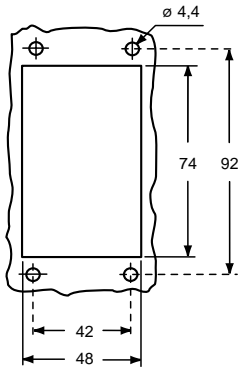

**Q IMPORTANT NOTE:** The enclosures ensure IP66/IP69 degree of protection (or IP65 for hinged cover versions) when mated and locked with the closing levers. The cover (CS, CP) only ensures mechanical protection, but does not ensure IP65 degree of protection.

**CAU<sup>®</sup>** Type 4/4X/12

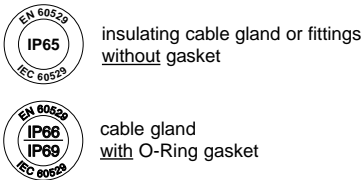

CHI

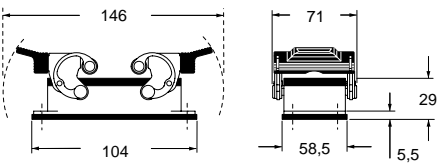

CHI CS

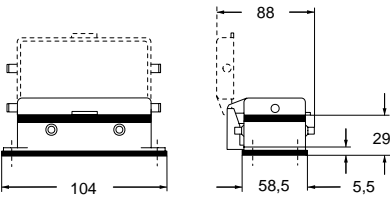

CHP and MHP

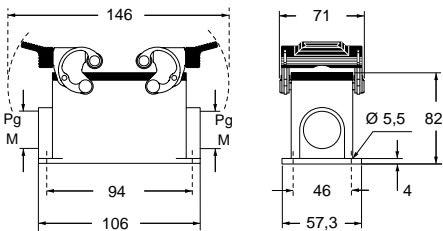

CHP CS and MHP CS

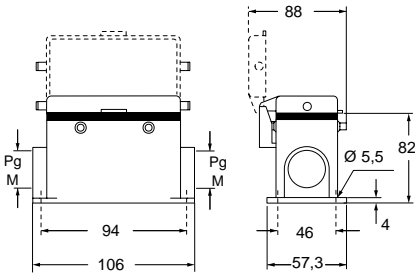

**CH - CA - CF and MH - MA - MF C-TYPE standard version**

## inserts

CD	50 poles + ⊕	71
CDD	76 poles + ⊕	80
CDA	32 poles + ⊕	102
CSAH	32 poles + ⊕	103
CDC	32 poles + ⊕	106

insert dimensions:  
2 x (66 x 16) mm

## page:

## hoods with 4 pegs



## hoods with 2 levers or 4 pegs



description	part No.	entry Pg	part No.	entry M	part No.	entry Pg	part No.	entry M
with pegs, side entry	<b>CHO 50</b>	21	<b>MHO 50.25</b>	25				
with pegs, side entry			<b>MHO 50.32</b>	32				
with pegs, side entry, high construction	<b>CAO 50.21</b>	21	<b>MAO 50.25</b>	25				
with pegs, side entry, high construction	<b>CAO 50.29</b>	29	<b>MAO 50.32</b>	32				
with pegs, top entry, high construction					<b>CAV 50.21</b>	21	<b>MAV 50.25</b>	25
with pegs, top entry, high construction					<b>CAV 50.29</b>	29	<b>MAV 50.32</b>	32
with levers and gasket, top entry, high construction					<b>CAV 50 G29</b>	29	<b>MAV 50 G32</b>	32
with pegs, side entry, high construction, without adapter 1)	<b>CFO 50.21</b>	21	<b>MFO 50.25</b>	25				
with pegs, side entry, high construction, without adapter 1)	<b>CFO 50.29</b>	29	<b>MFO 50.32</b>	32				
with pegs, top entry, high construction, without adapter 1)					<b>CFV 50.21</b>	21	<b>MFV 50.25</b>	25
with pegs, top entry, high construction, without adapter 1)					<b>CFV 50.29</b>	29	<b>MFV 50.32</b>	32
with levers and gasket, top entry, high, without adapter 1)					<b>CFV 50 G29</b>	29	<b>MFV 50 G32</b>	32

1) enclosure without adapter, threaded on the body, to be used only with a complete cable gland.

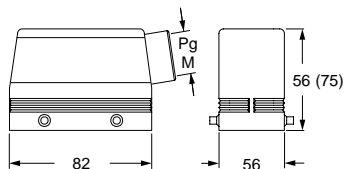
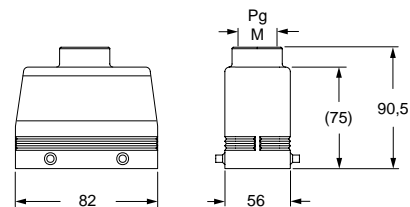
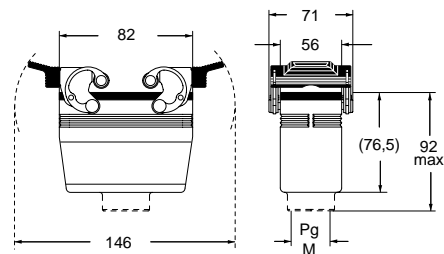
**CHO (CAO/CFO) and MHO (MAO/MFO)****CAV (CFV) and MAV (MFV)****CAV G (CFV G) and MAV G (MFV G)**

**CAI<sup>®</sup> US** Type 4/4X/12



insulating cable gland or fittings  
without gasket



cable gland  
with O-Ring gasket



CH - CA - CF and MH - MA - MF C-TYPE standard version

inserts		page:
CD	50 poles + ⊕	71
CDD	76 poles + ⊕	80
CDA	32 poles + ⊕	102
CSAH	32 poles + ⊕	103
CDC	32 poles + ⊕	106

insert dimensions:  
2 x (66 x 16) mm

hoods with 2 levers



covers



description	part No.	entry Pg	part No	entry M	part No. (with eyelet)	part No. (with loop)
with levers, side entry <sup>1)</sup>	CHO 50 X	21	MHO 50 X25	25		
with levers, side entry <sup>1)</sup>			MHO 50 X32	32		
with levers, side entry, high construction <sup>1)</sup>	CAO 50 X	21	MAO 50 X25	25		
with levers, side entry, high construction <sup>1)</sup>	CAO 50 X29	29	MAO 50 X32	32		
with levers, top entry, high construction <sup>1)</sup>	CAV 50 X	21	MAV 50 X25	25		
with levers, top entry, high construction <sup>1)</sup>	CAV 50 X29	29	MAV 50 X32	32		
with levers, side entry, high construction, without adapter <sup>1) 2)</sup>	CFO 50 X	21	MFO 50 X25	25		
with levers, side entry, high construction, without adapter <sup>1) 2)</sup>	CFO 50 X29	29	MFO 50 X32	32		
with levers, top entry, high construction, without adapter <sup>1) 2)</sup>	CFV 50 X	21	MFV 50 X25	25		
with levers, top entry, high construction, without adapter <sup>1) 2)</sup>	CFV 50 X29	29	MFV 50 X32	32		
with 4 pegs (for enclosures with 2 levers)					CHC 50	CHC 50 S
with 2 levers and gasket (for hoods with 4 pegs)						CHC 50 G

<sup>1)</sup> may be combined with enclosures:  
- CHI 50 CS, CHP 50 CS and MHP 50 CS

<sup>2)</sup> enclosure without adapter, threaded on the body,  
to be used only with a complete cable gland.

CHO X (CAO X/CFO X) and MHO X (MAO X/MFO X)

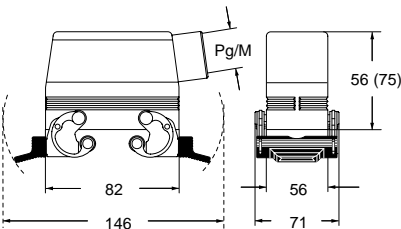

CAV X (CFV X) and MAV X (MFV X)

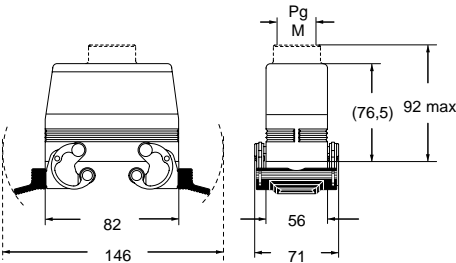

CHC(S)

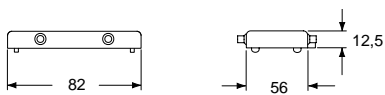

CHC G

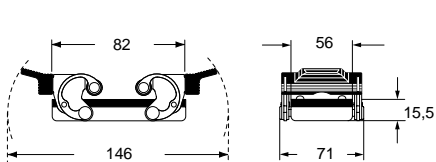

**CALUS**® Type  
4/4X/12



insulating cable gland or fittings  
without gasket



cable gland  
with O-Ring gasket

For fixing  
on housings

eyelet

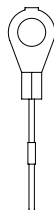

For fixing  
on hoods

loop

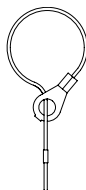

CAC C-TYPE standard version

inserts		page:
CD	50 poles + ⊕	71
CDD	76 poles + ⊕	80
CDA	32 poles + ⊕	102
CSAH	32 poles + ⊕	103
CDC	32 poles + ⊕	106

insert dimensions:  
2 x (66 x 16) mm

hoods without entry, to be drilled



description

part No.  
with 4 pegs

with pegs, high construction

CAC 50

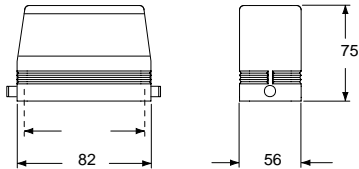

C-TYPE

**CAUS**® Type  
4/4X/12

