

## C-TYPE

### The classic choice

This series has been developed for application in electrical and electronic machinery, control units, electrical panels, control equipment, in industrial environments and in general, wherever a reliable and easily disconnectable connection is required for power and signal circuits.



#### SUM-UP

📌 **The inserts of the CMCE series (except the 16+2 poles) and of the CMSH series may use standard enclosures also for uses of up to 830V**

✔ **UL certified for USA and Canada for Type 4, 4X (outdoor use) and 12 (indoor use) degrees of protection (enclosure type rating), marked on the packaging.**  
IP65 or IP66/IP69 degrees of protection according to model.

#### 🔍 **Characteristics of materials for CH, CA and MH, MA, MF series**

- Made of die cast aluminium alloy;
- with epoxy-polyester thermosetting powder coating;
- gaskets in anti-aging, oil-resistant, grease-resistant and fuel-resistant vinyl nitrile elastomer;
- locking device with levers, springs and pins in stainless steel;
- lever handles in self-extinguishing thermoplastic material reinforced with glass fibres, UL approved (for CH, CA and MH, MA enclosures);
- ambient temperature range: -40 °C / +125 °C.



CH C-TYPE standard version

inserts		page:
CDD	24 poles + ⊕	76
CDS	9 poles + ⊕	-
CDSH	9 poles + ⊕	86
CDSH NC	6 poles + ⊕	95
CNE	6 poles + ⊕	110
CSE	6 poles + ⊕	-
CSH	6 poles + ⊕	110
CSH S	6 poles + ⊕	122
CCE	6 poles + ⊕	130
CSS	6 poles + ⊕	148
CT, CTSE (16A) *)	6 poles + ⊕	160
CQE	10 poles + ⊕	168
MIXO	2 modules	262 - 317

\*) can be used only in bulkhead mounting housings

bulkhead mounting housings with single lever



bulkhead mounting housings with 2 pegs



description	part No.	part No.
with lever	CHI 06 L	
with lever and cover	CHI 06 LS	
with pegs 1)		CHI 06 LC
with pegs and aluminum cover 1)		CHI 06 LCS
with pegs and plastic cover 1)		CHI 06 LCP

1) may be combined with enclosures:  
- CHO/CHV 06 LX  
- MHO/MHV 06 LX

panel cut-out for bulkhead mounting housings

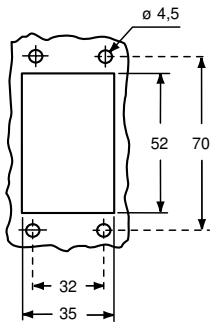

**Q IMPORTANT NOTE:** The enclosures ensure IP66/IP69 degree of protection (or IP65 for hinged cover versions) when mated and locked with the closing levers.  
The cover (CS, CP) only ensures mechanical protection, but does not ensure IP65 degree of protection.

CHI L ▲

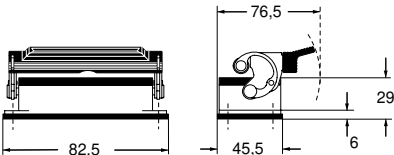

CHI LS ●

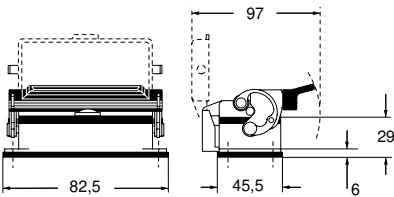

CHI LC ▲

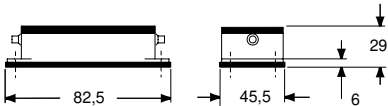

CHI LCS/LCP ●

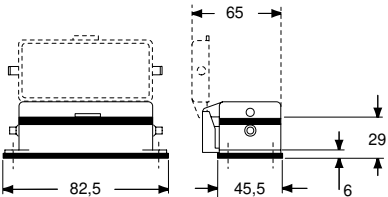

**CU<sup>®</sup>US** Type 4/4X/12  
(except enclosures with plastic cover)





CV - CVA and MV - MVA V-TYPE lever SIMPLEX self-closing covers

inserts		page:
CDD	24 poles + ⊕	76
CDS	9 poles + ⊕	-
CDSH	9 poles + ⊕	86
CDSH NC	6 poles + ⊕	95
CNE	6 poles + ⊕	110
CSE	6 poles + ⊕	-
CSH	6 poles + ⊕	110
CSH S	6 poles + ⊕	122
CCE	6 poles + ⊕	130
CSS	6 poles + ⊕	148
CT, CTSE (16A *)	6 poles + ⊕	160
CQE	10 poles + ⊕	168
MIXO	2 modules	262 - 317

\*) can be used only in bulkhead mounting housings

bulkhead mounting housings  
with stainless steel single lever



surface mounting housings  
with stainless steel single lever



description	part No.	entry Pg	part No.	entry M
with lever, gasket and cover in plastic	CVI 06 LSP			
with lever and cover		CVP 06 LSP16 16	MVP 06 LSP20 20	
with lever and cover, high construction		CVAP 06LSP21 21	MVAP 06LSP25 25	
with lever and cover, high construction		CVAP 06LSP29 29	MVAP 06LSP32 32	
with lever and cover, high construction			MVAP 06LSP40 40	

☑ The enclosures ensure IP65 degree of protection when mated and locked with the closing lever, or IP44 degree of protection when not mated and locked with lever.

panel cut-out for bulkhead mounting housings

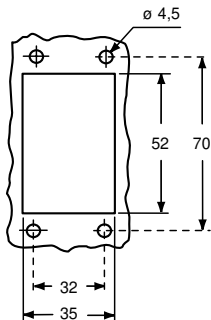

Hoods  
(from page 389)



CVI LSP

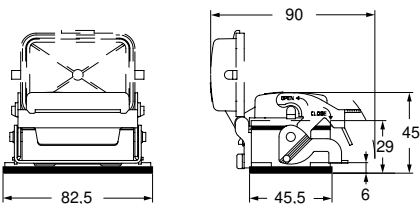

CVP - CVAP LSP and MVP - MVAP LSP

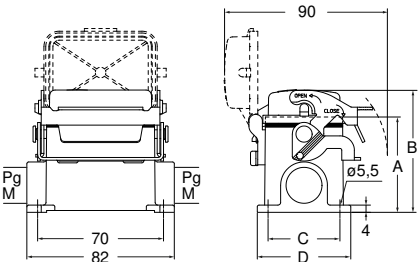

type	A	B	C	D
CVP / MVP 6 LSP	53	68	40	52
CVAP / MVAP 6 LSP	74	89	45	57

CEC® US Type 4/4X/12



CEC® US Type 4/4X/12 pending



**CH - CA and MH - MA C-TYPE standard version**

## inserts

CDD	24 poles + ⊕	76
CDS	9 poles + ⊕	-
CDSH	9 poles + ⊕	86
CDSH NC	6 poles + ⊕	95
CNE	6 poles + ⊕	110
CSE	6 poles + ⊕	-
CSH	6 poles + ⊕	110
CSH S	6 poles + ⊕	122
CCE	6 poles + ⊕	130
CSS	6 poles + ⊕	148
CQE	10 poles + ⊕	168
MIXO	2 modules	262 - 317

## page:

surface mounting housings  
with single leverangled surface mounting housings  
with single lever

description	part No.	entry Pg	part No.	entry M	part No.	entry M
with lever	CHP 06 L	16	MHP 06 L20	20		
with lever	CHP 06 L2	16 x 2	MHP 06 L220	20 x 2		
with lever, high construction 1)			MAP 06 L25	25		
with lever, high construction 1)			MAP 06 L225	25 x 2		
with lever, high construction	CAP 06 L	21	MAP 06 L32	32		
with lever, high construction	CAP 06 L2	21 x 2	MAP 06 L232	32 x 2		
with lever, high construction	CAP 06 L29	29	MAP 06 L40	40		
with lever, high construction	CAP 06 L229	29 x 2	MAP 06 L240	40 x 2		
with lever and cover	CHP 06 LS	16	MHP 06 LS20	20		
with lever and cover	CHP 06 LS2	16 x 2	MHP 06 LS220	20 x 2		
with lever and cover, high construction	CAP 06 LS	21	MAP 06 LS32	32		
with lever and cover, high construction	CAP 06 LS2	21 x 2	MAP 06 LS232	32 x 2		
with lever and cover, high construction	CAP 06 LS29	29	MAP 06 LS40	40		
with lever and cover, high construction	CAP 06 LS229	29 x 2	MAP 06 LS240	40 x 2		
with lever, cable gland entry, closed bulkhead 1) 2)					MAV 06LG25-F	25

1) be used only with a complete cable gland (to be purchased separately).

2) versions with M32, Pg 21 or Pg 29 entry on request.

**Q IMPORTANT NOTE:** The enclosures ensure IP66/IP69 degree of protection (or IP65 for hinged cover versions) when mated and locked with the closing levers. The cover (CS, CP) only ensures mechanical protection, but does not ensure IP65 degree of protection.

## CHP L - CAP L and MHP L - MAP L ▲

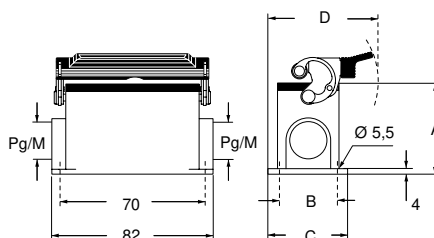

## MAV 06LG25-F ▲

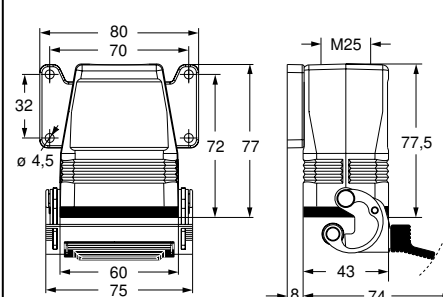

## CHP LS - CAP LS and MHP LS - MAP LS ●

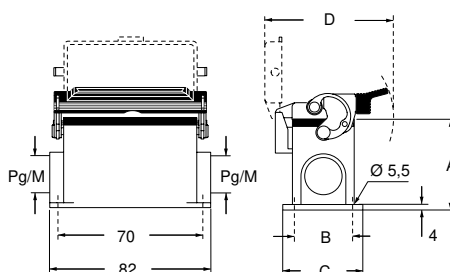

type	A	B	C	D
CHP L / MHP L	53	40	52	79,5
CAP L / MAP L	74	45	57	82
CHP LS / MHP LS	53	40	52	97
CAP LS / MAP LS	74	45	57	97

**CALUS** Type 4/4X/12



▲ insulating cable gland or fittings without gasket



▲ cable gland with O-Ring gasket



CH - CA - CF and MH - MA - MF C-TYPE standard version

inserts		page:
CDD	24 poles + ⊕	76
CDS	9 poles + ⊕	-
CDSH	9 poles + ⊕	86
CDSH NC	6 poles + ⊕	95
CNE	6 poles + ⊕	110
CSE	6 poles + ⊕	-
CSH	6 poles + ⊕	110
CSH S	6 poles + ⊕	122
CCE	6 poles + ⊕	130
CSS	6 poles + ⊕	148
CQE	10 poles + ⊕	168
MIXO	2 modules	262 - 317

hoods with 2 pegs



hoods with 2 pegs  
M40 cable entry with 20 mm thread length



description	part No.	entry Pg	part No	entry M	part No.	entry M
with pegs, side entry	CHO 06 L13	13,5	MHO 06 L20	20		
with pegs, side entry	CHO 06 L16	16	MHO 06 L25	25		
with pegs, side entry, high construction	CAO 06 L21	21	MAO 06 L25	25		
with pegs, side entry, high construction	CAO 06 L29	29	MAO 06 L32	32		
with pegs, side entry, high construction, without adapter <sup>1)</sup>	CFO 06 L21	21	MFO 06 L25	25		
with pegs, side entry, high construction, without adapter <sup>1)</sup>	CFO 06 L29	29	MFO 06 L32	32		
with pegs, side entry, high construction, without adapter <sup>1)</sup>					MFO 06 L40	40
with pegs, top entry <sup>2)</sup>	CHV 06 L13	13,5				
with pegs, top entry <sup>2) 3)</sup>			MHV 06 L20	20		
with pegs, top entry <sup>2)</sup>	CHV 06 L16	16	MHV 06 L25	25		
with pegs, top entry, high construction	CAV 06 L21	21	MAV 06 L25	25		
with pegs, top entry, high construction	CAV 06 L29	29	MAV 06 L32	32		
with pegs, top entry, high construction, without adapter <sup>1)</sup>	CFV 06 L21	21	MFV 06 L25	25		
with pegs, top entry, high construction, without adapter <sup>1)</sup>	CFV 06 L29	29	MFV 06 L32	32		
with pegs, top entry, high construction, without adapter <sup>1)</sup>					MFV 06 L40	40

<sup>1)</sup> enclosure without adapter, threaded on the body, to be used only with a complete cable gland.

<sup>2)</sup> cannot be used with MIXO series.

<sup>3)</sup> can only be used with a complete cable gland (to be purchased separately).

IP degrees are according to the type of lever of the counterpart enclosures.

Alternatively, hoods with pegs may be coupled with fixed enclosures:

- C-TYPE, IP65 or IP66/IP69 stainless steel lever, from page 387 to page 391
- C7, IP66/IP67/IP69 stainless steel lever, page 436
- CV, IP65 or IP66/IP69 stainless steel lever, page 444 and 445

CHO L (CAO L) and (CFO L)  
MHO L (MAO L) and (MFO L)

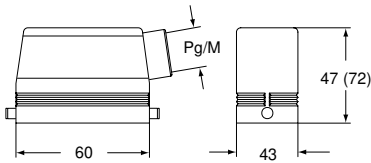

CHV L (CAV L) and [CFV L]  
MHV L (MAV L) and [MFV L]

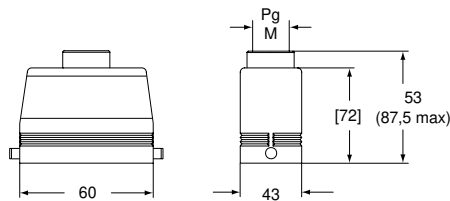

MFO 06 L40

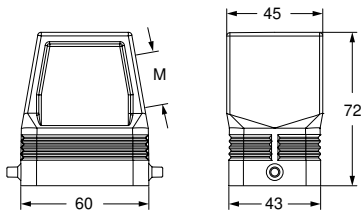

MFV 06 L40

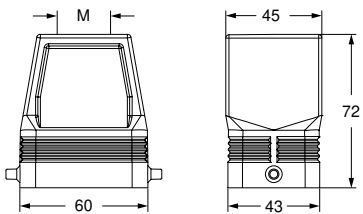

**CALUS** Type 4/4X/12



insulating cable gland or fittings without gasket



cable gland with O-Ring gasket  
IP67 if hoods without adapters coupled with IP67 housings

**CH - CA - CF and MH - MA - MF C-TYPE standard version**

inserts		page:
CDD	24 poles + ⊕	76
CDS	9 poles + ⊕	-
CDSH	9 poles + ⊕	86
CDSH NC	6 poles + ⊕	95
CNE	6 poles + ⊕	110
CSE	6 poles + ⊕	-
CSH	6 poles + ⊕	110
CSH S	6 poles + ⊕	122
CCE	6 poles + ⊕	130
CSS	6 poles + ⊕	148
CQE	10 poles + ⊕	168
MIXO	2 modules	262 - 317

**hoods with 1 lever****hoods with 1 lever  
M40 cable entry with 20 mm thread length**

description	part No.	entry Pg	part No	entry M	part No.	entry M
with lever, top entry	<b>CHV 06 LG</b>	16	<b>MHV 06 LG25</b>	25		
with lever, top entry, high construction	<b>CAV 06 LG21</b>	21	<b>MAV 06 LG25</b>	25		
with lever, top entry, high construction	<b>CAV 06 LG29</b>	29	<b>MAV 06 LG32</b>	32		
with lever, side entry, high construction, without adapter <sup>1)</sup>					<b>MFO 06 LG40</b>	40
with lever, top entry, high construction, without adapter <sup>1)</sup>	<b>CFV 06 LG21</b>	21	<b>MFV 06 LG25</b>	25		
with lever, top entry, high construction, without adapter <sup>1)</sup>	<b>CFV 06 LG29</b>	29	<b>MFV 06 LG32</b>	32		
with lever, top entry, high construction, without adapter <sup>1)</sup>					<b>MFV 06 LG40</b>	40

<sup>1)</sup> enclosure without adapter, threaded on the body, to be used only with a complete cable gland.

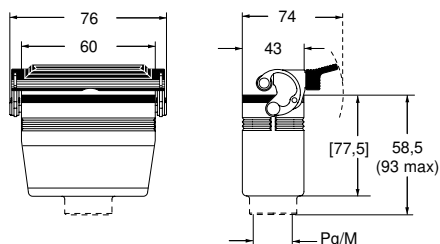
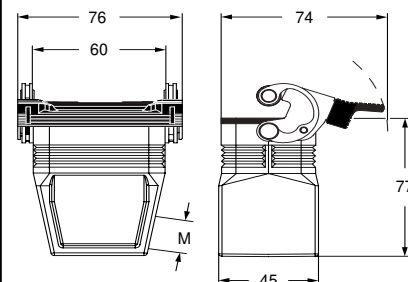
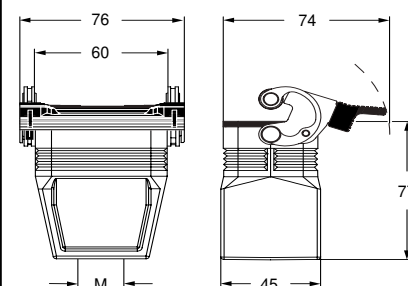
**CHV LG (CAV LG) and [CFV LG]  
MHV LG (MAV LG) and [MFV LG]****MFO 06 LG40****MFV 06 LG40**

**CAIUS**® Type  
4/4X/12



insulating cable gland or fittings  
without gasket



cable gland  
with O-Ring gasket



CH and MH C-TYPE standard version

inserts		page:
CDD	24 poles + ⊕	76
CDS	9 poles + ⊕	-
CDSH	9 poles + ⊕	86
CDSH NC	6 poles + ⊕	95
CNE	6 poles + ⊕	110
CSE	6 poles + ⊕	-
CSH	6 poles + ⊕	110
CSH S	6 poles + ⊕	122
CCE	6 poles + ⊕	130
CSS	6 poles + ⊕	148
CQE	10 poles + ⊕	168
MIXO	2 modules	262 - 317

hoods with 1 lever



covers



description	part No.	entry Pg	part No	entry M	part No. (with eyelet)	part No. (with loop)
with lever, without gasket, side entry <sup>1)3)</sup>	CHO 06 LX16	16	MHO 06 LX20	20		
with lever, without gasket, side entry <sup>1)3)</sup>			MHO 06 LX25	25		
with lever, without gasket, top entry <sup>1)3)</sup>	CHV 06 LX16	16	MHV 06 LX20	20		
with lever, without gasket, top entry <sup>1)3)</sup>			MHV 06 LX25	25		
with lever (for hoods with pegs)						CHC 06 LG
with pegs (for enclosures with lever)					CHC 06 L	CHC 06 SL
with pegs and gasket (for hoods with lever) <sup>2)</sup>						CHC 06 LC

<sup>1)</sup> may be combined with enclosures:  
CHI 06 LCS/LCP/LC

<sup>2)</sup> may be combined with enclosures:  
- CHO/CHV 06 LX  
- MHO/MHV 06 LX

<sup>3)</sup> cannot be used with MIXO series

CHCP 06  
dust protection cover  
(page 696)



CHO LX and MHO LX

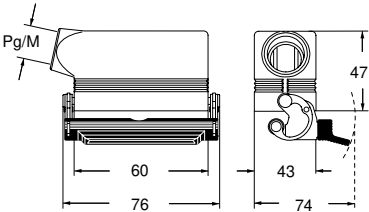

CHV LX and MHV LX

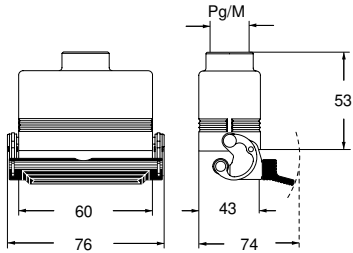

CHC LG

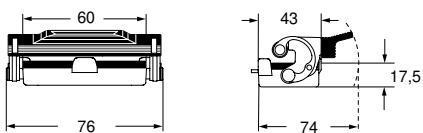

CHC L (SL)

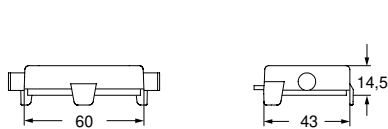

CHC LC

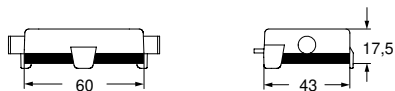

For fixing  
on housings

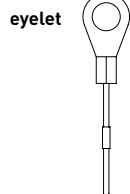

For fixing  
on hoods

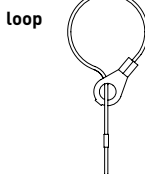

CALUS<sup>®</sup> Type  
4/4X/12



CAC C-TYPE standard version

inserts		page:
CDD	24 poles + ⊕	76
CDS	9 poles + ⊕	-
CDSH	9 poles + ⊕	86
CDSH NC	6 poles + ⊕	95
CNE	6 poles + ⊕	110
CSE	6 poles + ⊕	-
CSH	6 poles + ⊕	110
CSH S	6 poles + ⊕	122
CCE	6 poles + ⊕	130
CSS	6 poles + ⊕	148
CQE	10 poles + ⊕	168
MIXO	2 modules	262 - 317

hoods without entry, to be drilled



description

part No.  
(with 2 pegs)

with pegs, high construction

CAC 06 L

Alternatively, hoods with pegs are coupled with fixed enclosures:

- C-TYPE, IP65 or IP66/IP69 stainless steel lever, from page 387 to page 391
- C7, IP66/**IP67**/IP69 stainless steel lever, page 436
- CV, IP65 or IP66/IP69 stainless steel lever, page 444 and 445

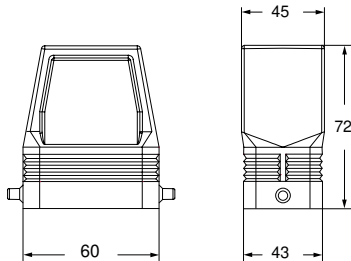

**CAUS**® Type  
4/4X/12



IP67 if coupled with IP67 hood or cover



# CH bulkhead connectors

inserts		page:
CD	40, 64 poles + ⊕	70, 72
CDD	24, 42, 72, 108 poles + ⊕	76 - 81
CDS	9, 18, 27, 42 poles + ⊕	-
CDSH	9, 18, 27, 42 poles + ⊕	86 - 89
CDSH NC	6 poles + ⊕	95
CNE	6, 10, 16, 24 poles + ⊕	110 - 113
CSE	6, 10, 16, 24 poles + ⊕	-
CSH	6, 10, 16, 24 poles + ⊕	110 - 113
CSH S	6, 10, 16, 24 poles + ⊕	122 - 125
CCE	6, 10, 16, 24 poles + ⊕	130 - 133
CMSH	3+2, 6+2, 10+2 (aux) poles + ⊕	136 - 140
CMCE	3+2, 6+2, 10+2 (aux) poles + ⊕	137 - 141
CSS	6, 10, 16, 24 poles + ⊕	148 - 151
CQE	10, 18, 32, 46 poles + ⊕	168 - 171
CQEE	40, 64 poles + ⊕	176 - 177
CP	6 poles + ⊕	178
CX	8/24, 6/36, 12/2 poles + ⊕	194 - 199
CX	4/0, 4/2, 4/8, 6/6 poles + ⊕	200 - 206
MIXO	2, 3, 4, 6 modules	262 - 317

## bulkhead mounting housings with 2 or 4 pegs



## bulkhead mounting housings



description	part No.	part No. C-TYPE	part No. C7
size "44.27"	CHI 06 LCH	CHI 06 L	C7I 06 L
size "57.27"	CHI 10 CH <sup>1)</sup>	CHI 10	C7I 10
size "77.27"	CHI 16 CH <sup>1)</sup>	CHI 16	C7I 16
size "104.27"	CHI 24 CH <sup>1)</sup>	CHI 24	C7I 24

<sup>1)</sup> may be combined also with enclosures:  
- surface mounting housings (CHP / MHP...)  
- hoods with lever and gasket (LG)

panel cut-out for bulkhead mounting housings

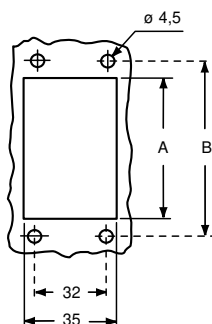

part No.	A	B
CHI 06 LCH - CHI 06 L - C7I 06 L	52	70
CHI 10 CH - CHI 10 - C7I 10	65	83
CHI 16 CH - CHI 16 - C7I 16	86	103
CHI 24 CH - CHI 24 - C7I 24	112	130

**IMPORTANT NOTE:** The enclosures ensure IP66 degree of protection when mated and locked with the closing levers.

**CAUS** Type 4/4X/12



### CHI LCH

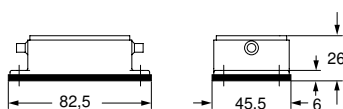

### CHI 10 CH

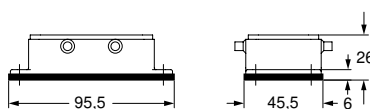

### CHI 16 CH

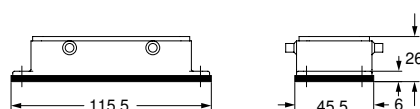

### CHI 16 CH

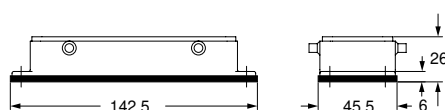

### CHI L

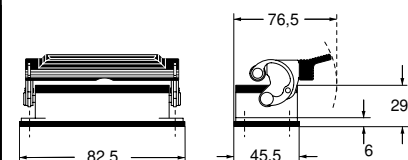

### CHI

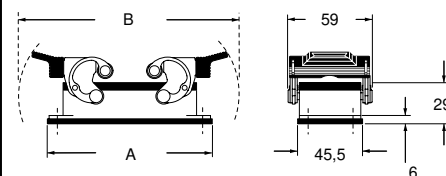

part No.	A	B
CHI 10	95,5	135
CHI 16	115,5	153
CHI 24	142,5	179,5

### C7I L

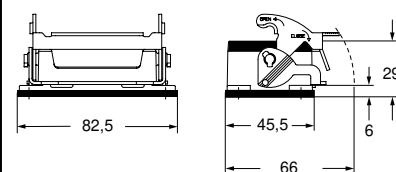

### C7I

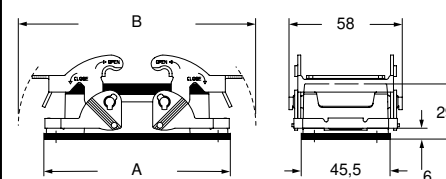

part No.	A	B
C7I 10	95,5	122
C7I 16	115,5	142,5
C7I 24	142,5	169

CYR cable passing hoods

enclosures:

size “77.27”  
size “104.27”

**Note:**  
cannot be used with T-TYPE series

cable passing hoods



description	part No.	size
with pegs for two levers		
3 holes for round cables Ø 5 - 13.5 mm	CYR 16.3	77.27
4 holes for round cables Ø 5 - 13.5 mm	CYR 24.4	104.27

CYR enclosures for round cables

The CYR enclosures are used in installations that require a passage for round cables for data transmission (e.g. computers or PLC) via equipment such as command or control panels, ensuring a good condition of the cable connections.

The enclosures are in two parts and have sealing gaskets to preserve the degree of protection of the equipment. The enclosures also contain a rapid cable block device.

The CYR 16.3 and 24.4 can be used with the **bulkhead mounting housings with 2 levers** respectively.

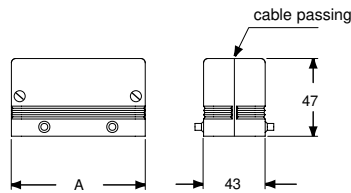

part No.	A	grommet entry	nr.	size
CYR 16.3	93,5	ø 5 / 13,5	3	77.27
CYR 24.4	120	ø 5 / 13,5	4	104.27

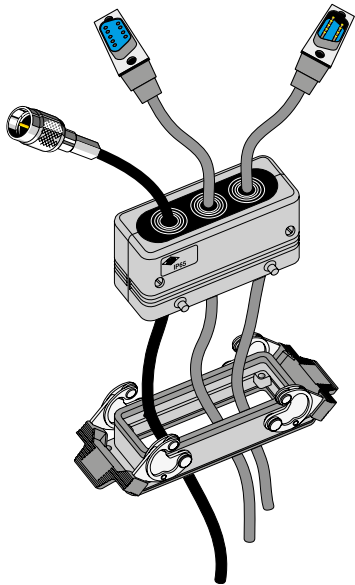

**CALUS** Type 12





CYG in-line joints

enclosures:  
size “77.27”

enclosures for in-line joints



**Note:**  
cannot be used with T-TYPE series  
and IP68 series

description	part No.
-------------	----------

without housings (to be ordered separately)  
made in two halves

CYG 16

- CYG 16 in-line joint**
- The joint is made with the CYG 16 enclosure and two bulkhead housings “size 77.27” with one or two levers (to be ordered separately).
  - The joint is ideal for use with extension connections and/or as adapter.
  - Made in two halves to facilitate conductor cabling.
  - Two inserts in various combinations may be inserted in the joint (to be ordered separately):
    - female/female inserts (as adapter joint)
    - male/male inserts (as adapter joint)
    - female/male inserts (as extension joint)

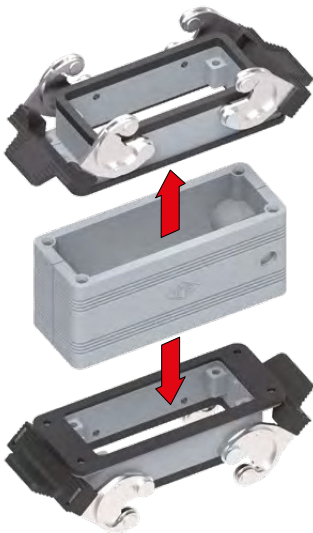
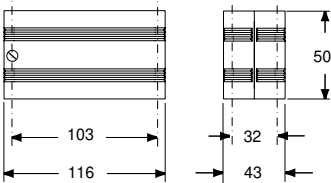

**CALUS**® Type 4/4X/12



SPECIAL ENCLOSURES

## CL – ML Standard version with IL-BRID levers

## inserts

CDD	24 poles + ⊕	76
CDS	9 poles + ⊕	-
CDSH	9 poles + ⊕	86
CDSH NC	6 poles + ⊕	95
CNE	6 poles + ⊕	110
CSE	6 poles + ⊕	-
CSH	6 poles + ⊕	110
CSH S	6 poles + ⊕	122
CCE	6 poles + ⊕	130
CSS	6 poles + ⊕	148
CT, CTSE (16A)*	6 poles + ⊕	160
CQE	10 poles + ⊕	168
MIXO	2 modules	262 - 317

\* can be used only in bulkhead mounting housings

refer to CN.19 pages

page:

bulkhead mounting housings  
with single lever

FROM SEPTEMBER 2022

surface mounting housings  
with single lever

FROM SEPTEMBER 2022

description	part No.	part No.	entry M
with lever	CLI 06 L		
with lever and cover	CLI 06 LS		
with lever		MLP 06 L20	20
with lever		MLP 06 L220	20 x 2
with lever, high construction		MLAP 06 L25	25
with lever, high construction		MLAP 06 L225	25 x 2
with lever, high construction		MLAP 06 L32	32
with lever, high construction		MLAP 06 L232	32 x 2
with lever, high construction		MLAP 06 L40	40
with lever, high construction		MLAP 06 L240	40 x 2
with lever and cover		MLP 06 LS20	20
with lever and cover		MLP 06 LS220	20 x 2
with lever and cover, high construction		MLAP 06 LS32	32
with lever and cover, high construction		MLAP 06LS232	32 x 2
with lever and cover, high construction		MLAP 06 LS40	40
with lever and cover, high construction		MLAP 06LS240	40 x 2

## panel cut-out for bulkhead mounting housings

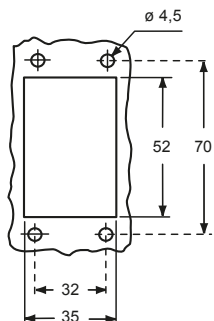

**IMPORTANT NOTE:** The enclosures ensure IP66/IP69 degree of protection (or IP65 for hinged cover versions) when mated and locked with the closing levers.

cURus  
Type 4/4X/12 pending  
(except enclosures with plastic cover)



insulating cable gland or fittings  
without gasket



cable gland  
with O-Ring gasket

## CLI 06 L ▲

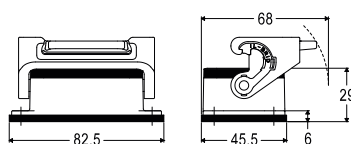

## CLI 06 LS ●

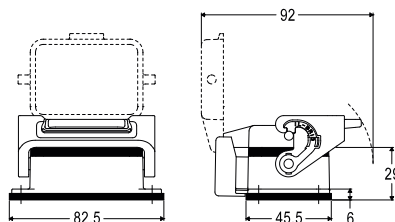

## MLP 06 L

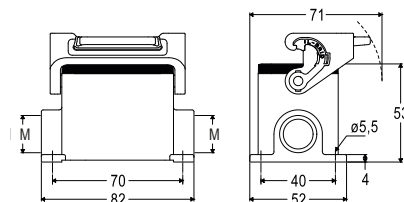

## MLAP 06 LS ●

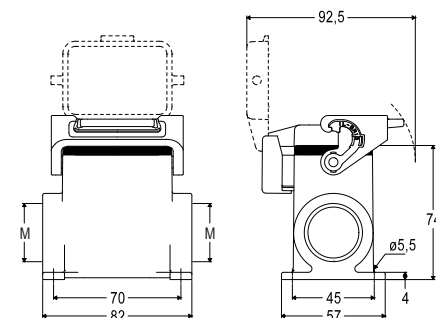

## ML – MLA Standard version with IL-BRID levers

## inserts

CDD	24 poles + ⊕	76
CDS	9 poles + ⊕	-
CDSH	9 poles + ⊕	86
CDSH NC	6 poles + ⊕	95
CNE	6 poles + ⊕	110
CSE	6 poles + ⊕	-
CSH	6 poles + ⊕	110
CSH S	6 poles + ⊕	122
CCE	6 poles + ⊕	130
CSS	6 poles + ⊕	148
CQE	10 poles + ⊕	168
MIXO	2 modules	262 - 317

page:

## hoods with 1 lever



## hoods with 1 lever

M40 cable entry with 20 mm thread length



refer to CN.19 pages

FROM SEPTEMBER 2022

FROM SEPTEMBER 2022

description	part No.	entry M	part No.	entry M
with lever, top entry	<b>MLV 06 LG25</b>	25		
with lever, top entry, high construction	<b>MLAV 06 LG25</b>	25		
with lever, top entry, high construction	<b>MLAV 06 LG32</b>	32		
with lever, side entry, high construction, without adapter <sup>1)</sup>			<b>MLFO 06 LG40</b>	40
with lever, top entry, high construction, without adapter <sup>1)</sup>	<b>MLFV 06 LG25</b>	25		
with lever, top entry, high construction, without adapter <sup>1)</sup>	<b>MLFV 06 LG32</b>	32		
with lever, top entry, high construction, without adapter <sup>1)</sup>	<b>MLFV 06 LG40</b>	40		

<sup>1)</sup> enclosure without adapter, threaded on the body, to be used only with a complete cable gland.

## MLV 06 LG

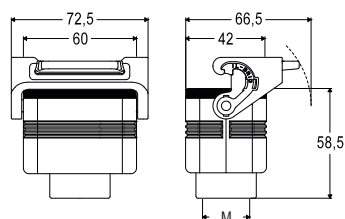

## MLAV 06 LG

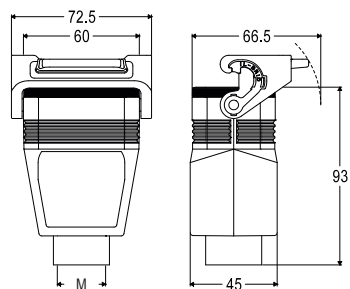

## MLFV 06 LG

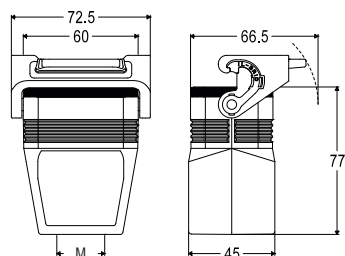

## MLFO 06 LG

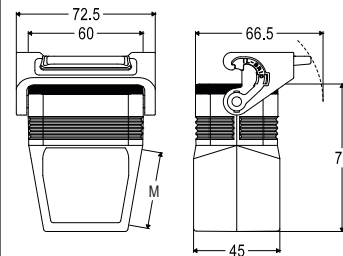

cURus  
Type 4/4X/12 pending



insulating cable gland or fittings  
without gasket



cable gland  
with O-Ring gasket